

Case Research

Fitzpatrick, Karen

From: Projectinput
Sent: Wednesday, May 11, 2016 4:36 PM
To: Projectinput
Subject: Online Pre-Application Submitted (416-PA-2016)



Pre-Application Number: **416-PA-2016**
Project Name: **Parking Addition - Perimeter Center**
Location: **8777 E HARTFORD DR**

Contact Name: **Michael Schmitt**
Contact Phone: **602-761-5120**
Contact Email: mschmitt@dfdg.com



© 2016 City of Scottsdale. All Rights Reserved.



*Flood AO-1
Zone*

Preliminary to grade

Final - w/CD'S

GENERAL NOTE: ALL NEW GROUND UTILITY EQUIPMENT OR VAULTS TO BE SCREENED WITH SCREEN WALL TO MATCH EXISTING

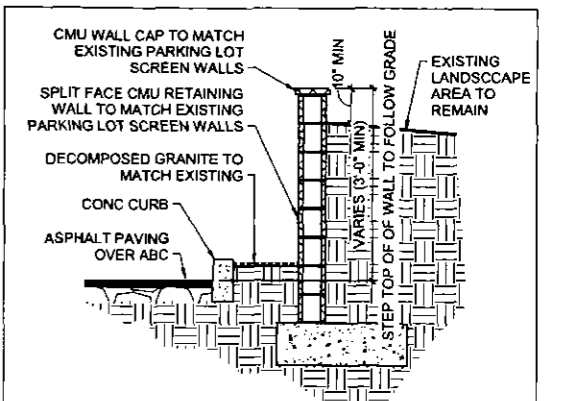
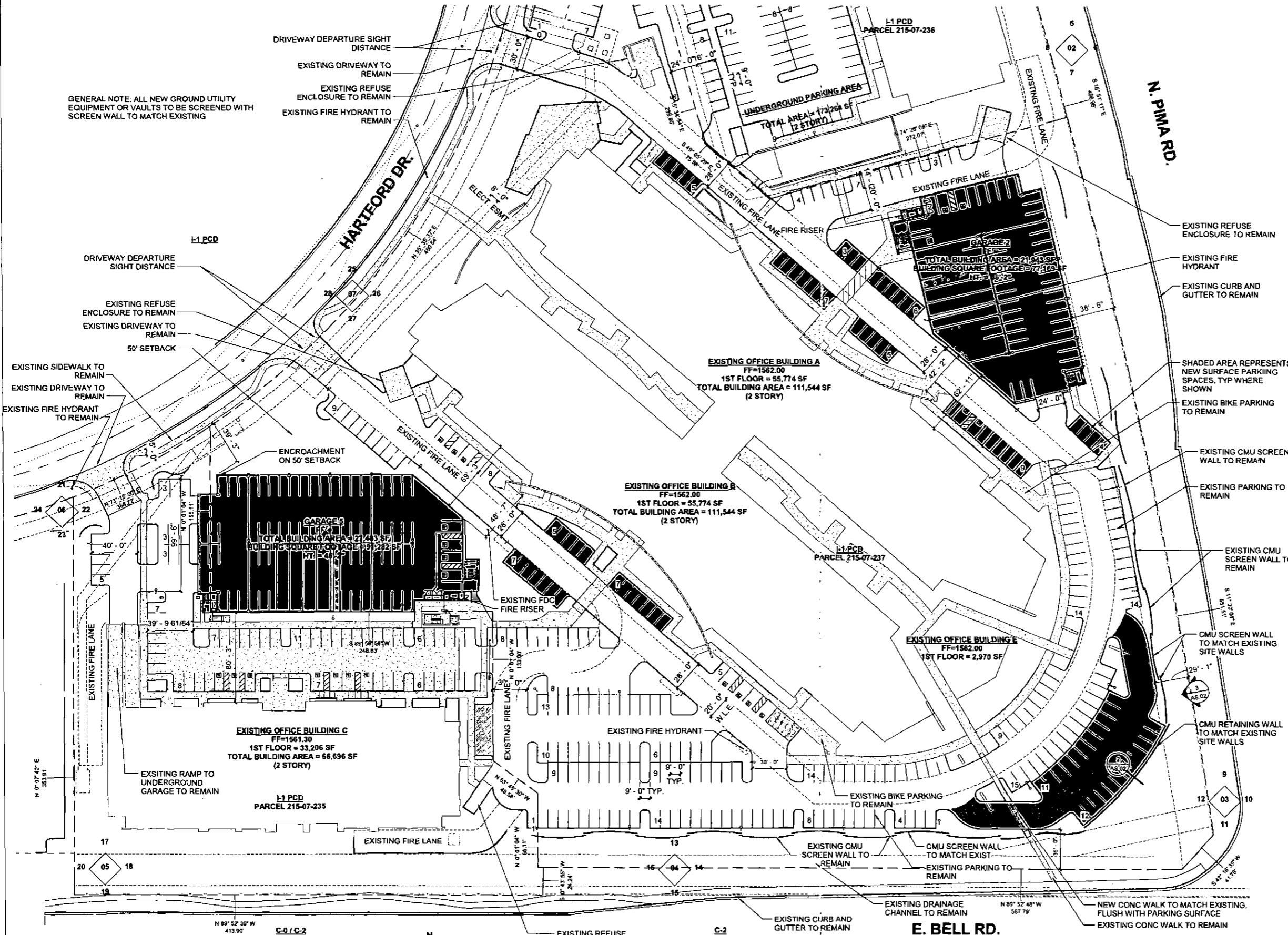

2 Retaining Wall At New Parking
1/2" = 1'-0"

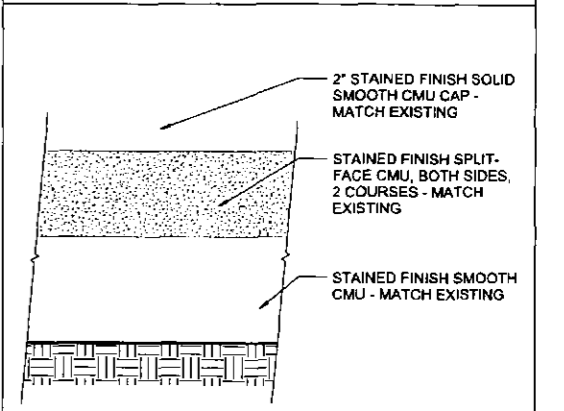

3 Typical Screen Wall Elevation
3/4" = 1'-0"

1 Partial Enlarged Site Plan
1" = 40'-0"

PARTIAL ENLARGED SITE PLAN

D&D
Architectural
Dick & Fritsch Design Group
4545 East McKinley Street
Phoenix, Arizona 85008
Telephone 602.954.9060
Fax 602.954.6954
www.dfdg.com

10/19/16
PRELIMINARY: NOT FOR CONSTRUCTION
Wentworth Properties
68-DR-2000 #5
10/28/2016
AS.02