

# TOPOGRAPHICAL SURVEY

SOUTHWEST CORNER OF DRIVEWAY OF  
SAFeway STORE #1849  
LOCATED IN A PORTION OF THE NORTHWEST CORNER OF SECTION 14,  
TOWNSHIP 5 NORTH, RANGE 4 EAST OF THE GILA AND SALT RIVER  
BASE AND MERIDIAN

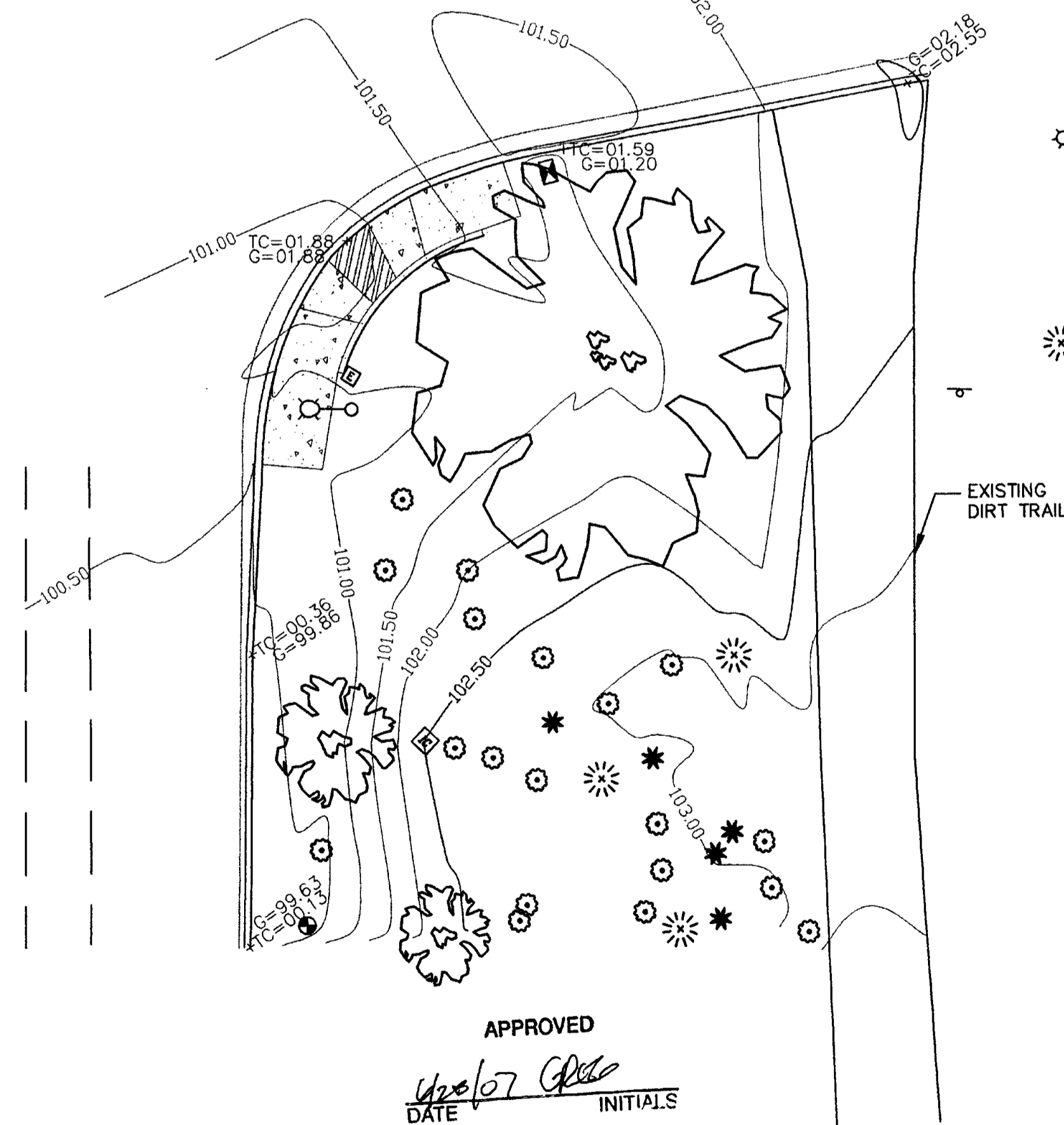
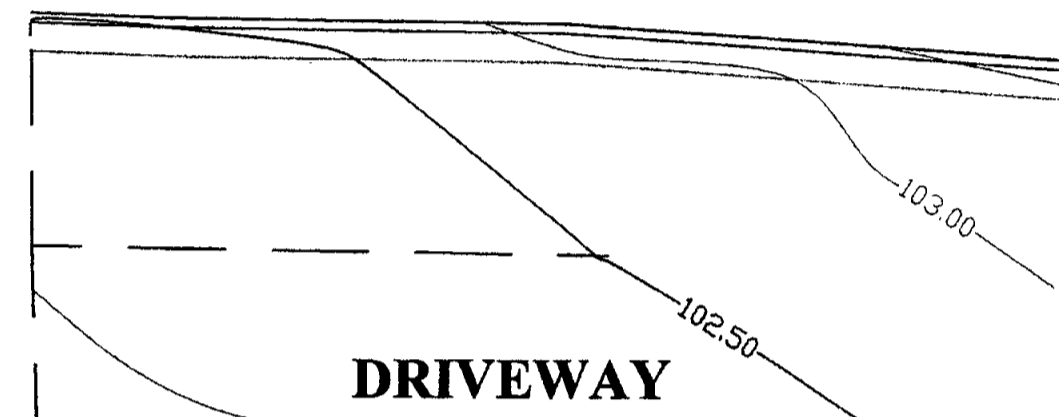
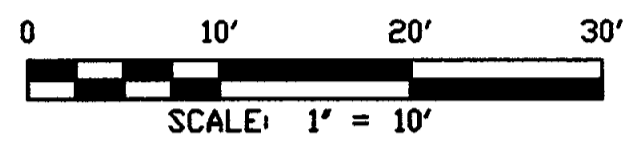

APPROVED

*[Signature]*  
DATE INITIALS

TBM 600 NAIL  
WITH WHISKERS  
EL=100.00

PROJECT  
SITE

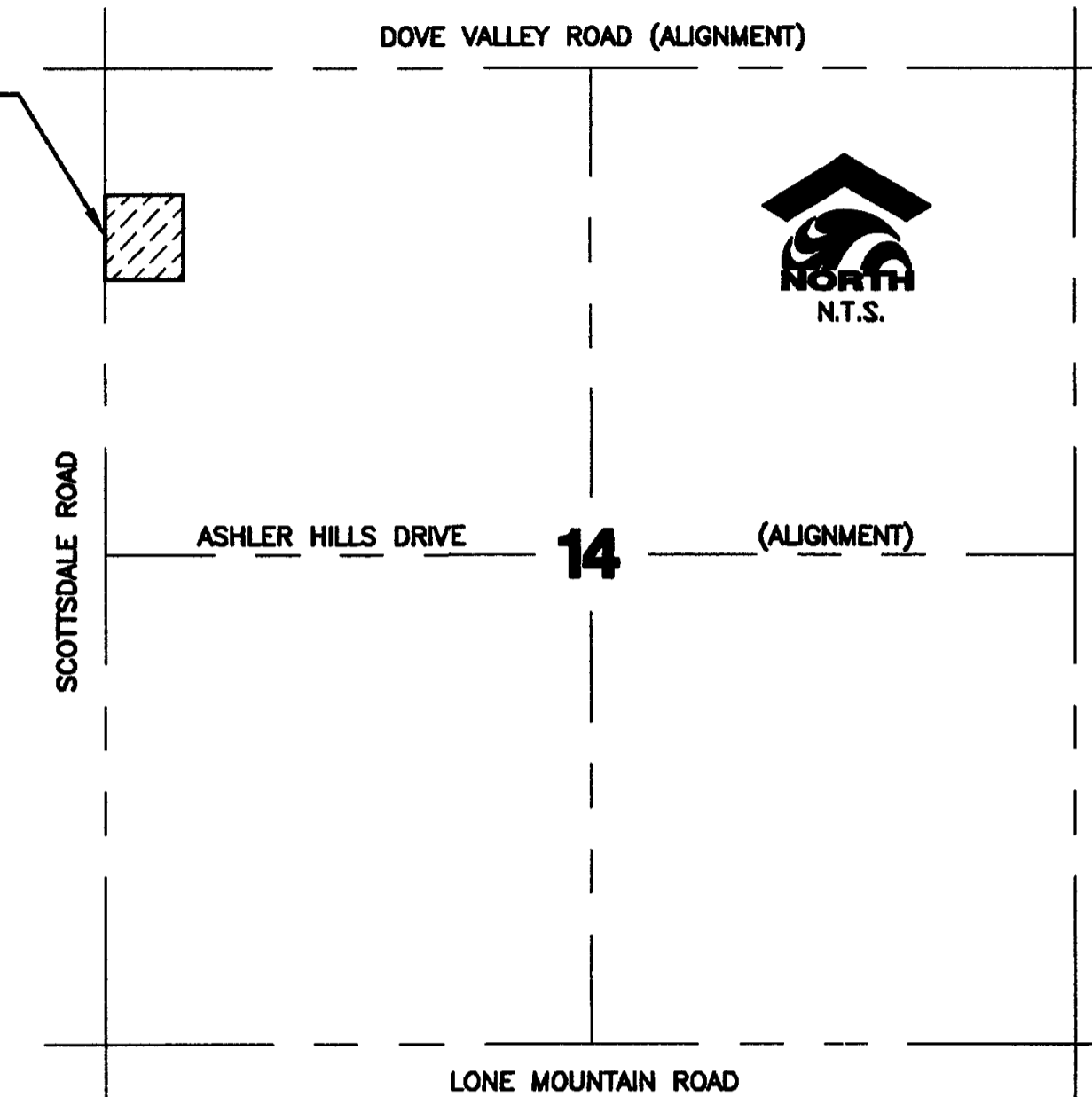

VICINITY MAP



Stantec Consulting  
8211 South 48th Street  
Phoenix AZ U.S.A.  
85044  
Tel. 602.438.2200  
Fax. 602.431.9562  
www.stantec.com

**Stantec**

Copyright Reserved

The Contractor shall verify and be responsible for all dimensions. DO NOT scale the drawing - any errors or omissions shall be reported to Stantec without delay.  
The Copyrights to all designs and drawings are the property of Stantec. Reproduction or use for any purpose other than that authorized by Stantec is forbidden.

Legend

- TEMPORARY BENCH MARK
  - AREA LIGHT
  - BARREL CACTUS
  - TREE
  - BUSH
  - MISC. CACTUS
  - TRAIL SIGN
  - TRANSFORMER
  - STREET LIGHT
  - ELECTRIC PULL BOX
  - FIRE HYDRANT
  - IRRIGATION CONTROL VALVE
  - STREET STRIPPING
  - CURB AND GUTTER
- SPOT GRADES ADD 100'  
+TC=03.44 TOP OF CURB ELEV.  
+C=03.44 GUTTER ELEV.

### PROJECT BENCHMARK

ELEVATIONS ARE BASED ON AN ASSUMED ELEVATION FOR THE TBM.  
TBM ELEV.=100.00 NAIL WITH WHISKERS  
LOCATED IN THE LANDSCAPED AREA IN  
THE SOUTHWEST CORNER OF JOB SITE

Revision	By	Appd.	YY.MM.DD
File Name: 10241base.dwg	JRC		03/07/07
Permit-Seal	Dwn.	Chkd.	Dgn.

### CERTIFICATION

I, EDWIN M. BALLIET, R.L.S. HEREBY CERTIFY THAT I AM A REGISTERED LAND SURVEYOR IN THE STATE OF ARIZONA, THAT THIS DRAWING CORRECTLY REPRESENTS A SURVEY MADE UNDER MY DIRECTION DURING THE MONTH OF MARCH, 2007, TO THE BEST OF MY KNOWLEDGE THIS SURVEY IS TRUE AND COMPLETE AS SHOWN.

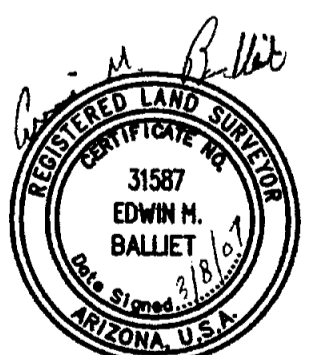

Client/Project

**SAFeway INC.**  
2750 S. PINEST DR.  
TEMPE, ARIZONA

Title

Topographical Survey

118-DR-1999#6  
3/14/2007

Project No.	Scale	
181910241	AS NOTED	
Drawing No.	Sheet	Revision
181910241	1 of 1	1