

CITY COUNCIL REPORT



Meeting Date: *June 23, 2026*
General Plan Element: *Land Use*
General Plan Goal: *Support a diversity of businesses.*

ACTION

Liquor License Request for LL-0023-2026 Turnout Beverage (390108) To consider forwarding a recommendation of approval to the Arizona Department of Liquor Licenses and Control for a New Application Series 4 (wholesaler) State liquor license for a new location and new owner.

OWNER

Turnout Beverage LLC

APPLICANT CONTACT

James Andrew Erickson

LOCATION

7325 E Evans Rd, #2403

REQUEST

The applicant is seeking a favorable recommendation on a Series 4 (wholesaler) liquor license for a new location and new owner.

This liquor license allows a wholesaler to warehouse and distribute for sale, all types of spirituous liquor to licensed retailers within the permissions of the retail license.

IMPACT ANALYSIS

Action Taken _____

Reliability and Location

A.R.S. Section 4.-203.A and R19-1-702 Granting a License for a New Owner and Location

The capability, qualifications and reliability of the applicant has been shown, and the public convenience and best interest of the community will be substantially served by the issuance.

Zoning

This site is zoned Industrial Park (I-1). The I-1 district allows wholesale as a permitted use. The applicant has been notified of the city's expectation that the business will operate as a wholesaler.

Parking and Traffic

The surrounding street network provides sufficient access.

Public Safety

Police Department: No Opposition
Major life safety issues: None noted

Public Notice and Proximity

A.R.S. Section 4-201. B. Petitions from Persons in Close Proximity

A.R.S. Section 4-207. Restrictions on Licensing premises near school or church buildings (within 300 ft.) applies to all but Series 5,11,12, Special Events, or Golf Courses.

The applicant has maintained the required posting notice for the State mandated 20-day period. No petitions or protests were received during the 20 (twenty) day posting period.

There are no school buildings or church buildings within 300 feet. Other surrounding uses are compatible.

COUNCIL OPTIONS & STAFF RECOMMENDATION

Council Options

The City Council has the option of recommending approval, disapproval or no recommendation to the Arizona Department of Liquor Licenses and Control.

Staff Recommendation

Staff advises that the license request meets the criteria imposed for determining that the community's best interest is substantially served by the issuance of the liquor license and advises that the license request meets the criteria imposed for determining the capability, qualifications, and reliability of the applicant.

Next Steps

The City Council's recommendation will be forwarded to the Department of Liquor Licenses and Control for their consideration. If the application is approved by the Department of Liquor Licenses and Control, the applicant should receive their license from the State within 105 days of original application.

RESPONSIBLE DEPARTMENT(S)

Caitlin Clark Planning Technician, cclark@scottsdaleaz.gov
Planning and Development Services

Matt Evans, Commander, mevans@scottsdaleaz.gov
Special Operations Division

APPROVED BY



Tim Curtis, AICP, Current Planning Director
480-312-4210, tcurtis@scottsdaleaz.gov

6/9/2026

Date

ATTACHMENTS

1. Map
2. City of Scottsdale Applicant Questionnaire
3. State Application (Front page)
4. Floor Plan

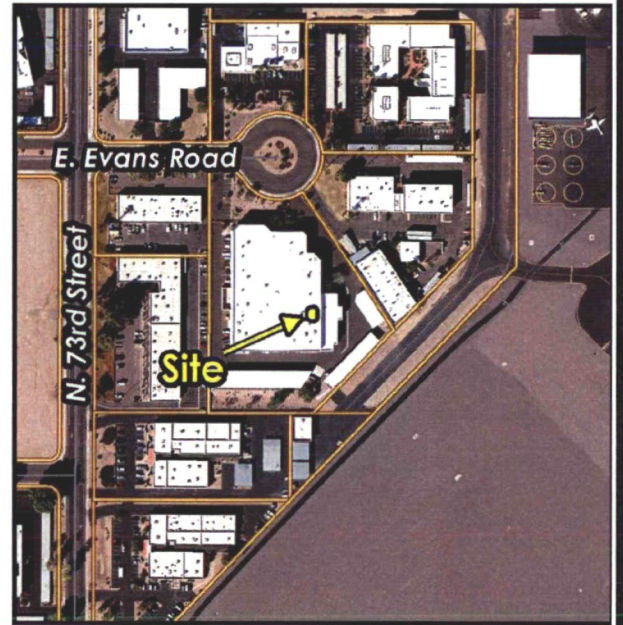
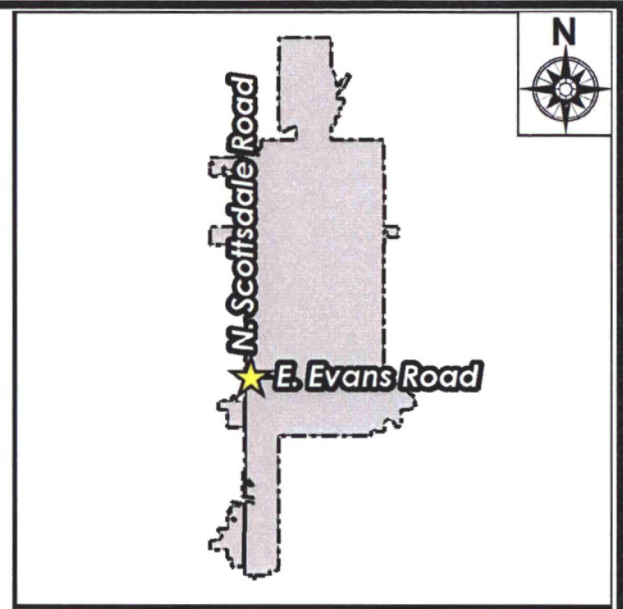
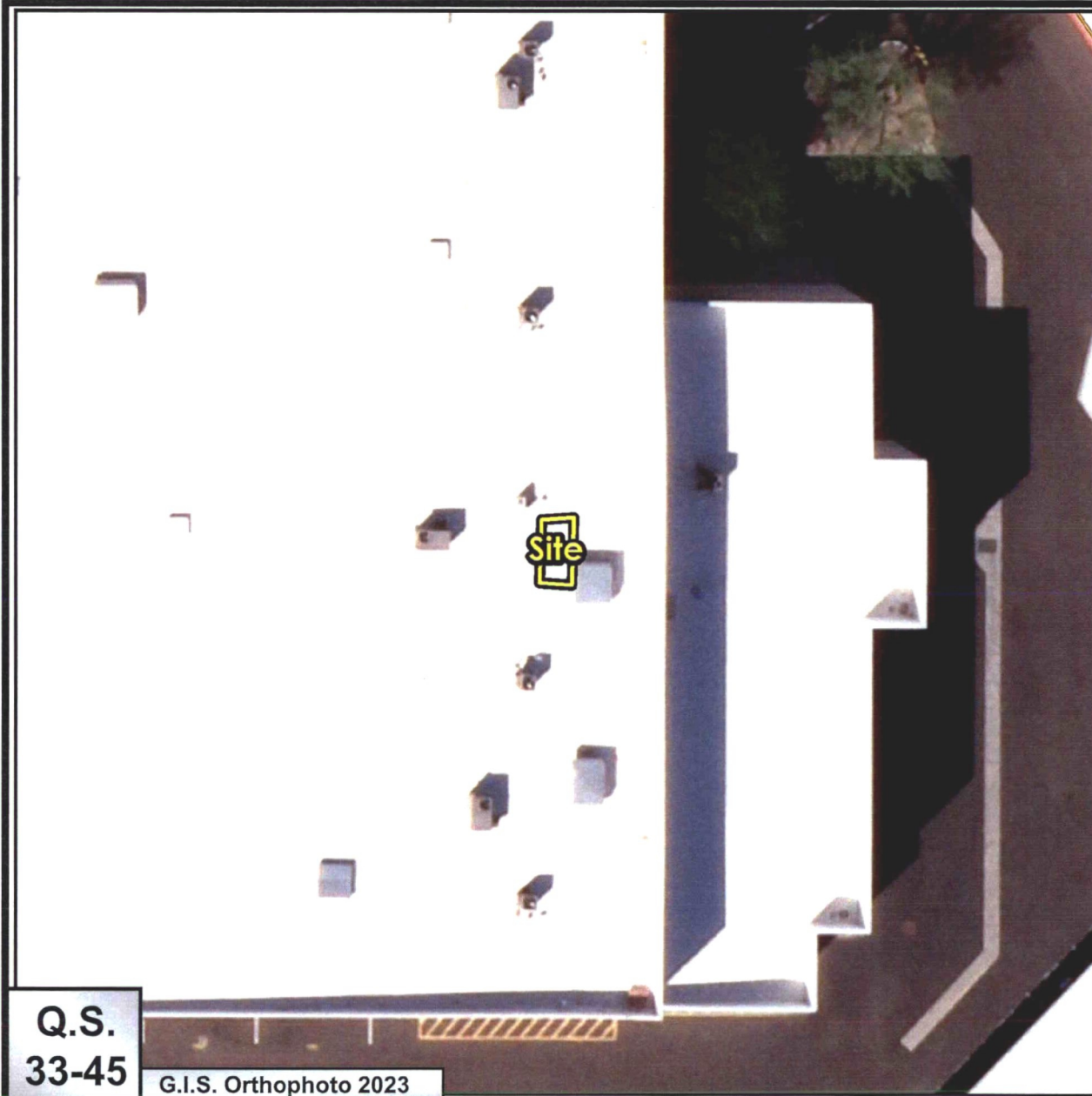

Q.S.
33-45

G.I.S. Orthophoto 2023

LL-0023-2026

Turnout Beverage (390108)

Liquor License Questionnaire

(New Location)



Packaged Retail, Wholesale, Manufacturing (Series 1, 2, 3, 4, 9, 10, 19)

Please complete all questions and return within 3 business days.

Name of Business:	Turnout Beverage
Business Address:	7325 E Evans Rd., Scottsdale AZ 85260
Type of Business (packaged retail, wholesale, manufacturing):	Wholesale
Total Gross Square Footage of Establishment:	100
Was liquor sold at this location prior to this application? Yes <input type="checkbox"/> No <input checked="" type="checkbox"/>	
If yes, what type of license?	
Is this business currently open? Yes <input type="checkbox"/> No <input checked="" type="checkbox"/>	
If yes, is this business operating with an interim license? Yes <input type="checkbox"/> No <input checked="" type="checkbox"/>	
If no, what is the proposed opening date?	7 1 2026
Is this business under construction? Yes <input type="checkbox"/> No <input checked="" type="checkbox"/>	
Is this business being remodeled? Yes <input type="checkbox"/> No <input checked="" type="checkbox"/>	
Does this business have a drive thru window? Yes <input type="checkbox"/> No <input checked="" type="checkbox"/>	

Applicant Narrative:

ARS 4-201-G: Except for a person to person transfer of a transferable license for use at the same location and as otherwise provided in section 4-203, subsection A, in all proceedings before the governing body of a city or town, the board of supervisors of a county or the board, the applicant bears the burden of showing that the public convenience requires and that the best interest of the community will be substantially served by the issuance of a license.

1. I have the capability, qualifications and reliability to hold a liquor license because:

I have significant experience operating within the regulated beverage industry and a thorough understanding of Arizona liquor laws and compliance requirements. The business is structured with established procedures to ensure adherence to all applicable

2. The best interest of the community will be substantially served by the issuance of the liquor license because:

The issuance of this license will support the orderly distribution of alcoholic beverages within Arizona's three-tier system by allowing additional products to be made available through licensed distributors to local retailers. This enhances consumer choice without

3. Please describe your business:

The business is a wholesale beverage company operating within Arizona's three-tier system. Products are produced by a licensed manufacturer and sold to a licensed distributor who then supplies retail accounts. The licensed premises will function as the

Planning and Development Services

7447 E. Indian School Road, Suite #105, Scottsdale, AZ 85251 • www.ScottsdaleAZ.gov

Liquor License Questionnaire

(New Location)

Packaged Retail, Wholesale, Manufacturing (Series 1, 2, 3, 4, 9, 10, 19)



Please complete all questions and return within 3 business days.

The City's forwarding of a recommendation to the AZ Department of Liquor Licenses and Control does not waive and is not a substitute for the Licensee's obligation to comply with all state, local and federal laws, policies and regulations applicable to the license. The Recommendation is not a permit or regulatory approval to hold any events or construct or demolish any improvements. Zoning processes, building permit processes, and similar regulatory requirements may apply to Licensee's contemplated Improvements and are completely separate from the Recommendation. Licensee shall be responsible to, separate and apart from this Recommendation, directly obtain all necessary permits and approvals from any and all governmental or other entities including the City's having standing or jurisdiction over the subject areas. For more information regarding zoning processes, building permit processes, and similar regulatory requirements and approvals please call 480-312-2611.

James Erickson

04/30/2026

Print Name

Agent/Applicant Signature

Date

Planning and Development Services

7447 E. Indian School Road, Suite #105, Scottsdale, AZ 85251 • www.ScottsdaleAZ.gov

Extra Space Warehouse
Turnout Beverage
#2403
7325 E Evans Rd
Phoenix, AZ 85260

Property Owner Info:
Carolyn Potter
7325 E Evans Road
Scottsdale AZ 85260

