



# Special Event Application

10/1/2024

Standard

149-SE-2024

## Event Information

Event Name LIVE MUSIC AT VIG MCDOWELL MAN FOR WM OPEN  
 Event Location 10199 E BELL RD  
 Event URL THEVIG.US  
 Event Description LIVE MUSIC ON VIG PATIO FROM 4-7 FEB. 7TH AND 8TH

## Event Dates

Event Dates (1)	Start Date	End Date	Participant Attendance	Other Attendance
	FRI 2/7/2025 4:00 PM	FRI 2/7/2025 7:00 PM	100	25

Setup Date FRI 2/7/2025 3:30 PM - 04:00 PM  
 Teardown Date SAT 2/8/2025 7:00 PM - 07:30 PM

## Applicant Information

Applicant VIG MCDOWELL MTN  
 Applicant Address 10199 E BELL RD  
 Applicant City SCOTTSDALE, AZ 85260  
 Applicant Name JEFF BARTON  
 Title PARTNER  
 Phone (602) 369-7585 Email JEFF@ANCALAMARKETING.COM  
 On-Site Contact JEFF BARTON  
 Title PARTNER  
 Phone (602) 369-7585 Email JEFF@ANCALAMARKETING.COM

Applicant Experience WE HAVE DONE THIS EVENT FOR 7 YEARS IN A ROW

## Prior Events

Has this event been produced before? YES

Is this an annual event? YES Previous Years : 7

Are there any changes from previous years? NO

## Event Elements

Elements ENTERTAINMENT, RECREATIONAL  
 Description LIVE MUSIC FOR GUESTS OF THE WM OPEN

## Public Property Criteria

Are there any cross promotions or collaborations with local businesses to encourage sales or visibility? NO

NAT NATHAN AND THE MCDADDYS WILL PERFORM AND PART OF THE PROCEEDS WILL GOT TO THE MCDOWELL CONSERVANCY



# Special Event Application

10/1/2024

Standard

149-SE-2024

Explain any anticipated regional, national, or international attendance.

NONE

Is Scottsdale promoted in the special event marketing? NO

Explain how the community benefits from the event from a civic or cultural perspective.

LIVE MUSIC FOR WM OPEN GUESTS

Does your event require a paid fee for participants and/or spectators? NO

## Event Equipment

Stages	NO	Tables, Chairs, Furniture	NO
Generators	NO	Inflatables	NO
Portable Bars	NO	Amplified Sound	NO
Speakers	YES QTY: 1-2	Temporary Restrooms	NO
Fencing	NO	BBQ Grills or Propane Use	NO
Lighting	NO	Tents/Canopies	NO

## Vendor Sales

Retail Merchandise	NO	Food And Non-Alcoholic Beverages	NO
Food Trucks	NO	Alcohol	NO
Services	NO		

## Signage Plan

On-Site Signs? YES QTY: 3 TYPE: PORTABLE (A-FRAME- SITS ON TOP OF GROUND)

Off-Premise Signs? NO

Signage Plan Description:

ON SITE A FRAME SIGNS

## Parking Plan

City parking lot	NO	City parking garage	NO
On-street parking	NO	On-site parking	YES
Off-site parking	NO	Shuttle service from off-site parking areas	NO
Valet service	NO	Rider Provider	NO

Parking Plan Description



# Special Event Application

10/1/2024

Standard

149-SE-2024

WE HAVE ENOUGH PARKING ON SITE FOR THE EVENT

## Street Use

Street or Alley Use

Street Closure : NO

Public Parking Use

Parking Closure : NO

Sidewalk Use

Sidewalk Closure : NO

Barricade Company

## Entertainment - Amplification/Sound Plan

Entertainment

LIVE BAND

Sound Monitoring

Name : JEFF BARTON

Company : VIG MCDOWELL MTN

Phone Number : (602) 369-7585

Time and type of outside sound and sound check times

4 TO 7 PM MANAGEMENT WILL MONITOR THE SOUND

Plan for sound monitoring, containment, and mitigation

ONSITE MANAGERS WILL MONITOR SOUND VOLUMES

## Police/Security

Security Personnel

Inhouse Security YES Estimated Number : 3

Hired Security NO

Off Duty Police NO

## Scottsdale Fire Department and Medical Standby Services

Fire Department Permit Required NO

Medical Standby NO

Fire Apparatus/Personnel Standby Required NO

## Insurance



# Special Event Application

10/1/2024

Standard

149-SE-2024

Insurance: Event activities on City/public property must be covered by insurance that protects the event sponsor/applicant and the City of Scottsdale. Various types and levels of liability insurance are required depending on the event. The required coverage and limits will be at the discretion of the Risk Management Division depending on the size and scope of the event. It is recommended that you submit your application and receive a determination on coverage and amounts before purchasing insurance coverage. Please refer to the Special Events Users Guide for more detailed information.

The following is a general guideline of the minimum limits that will be required:

Commercial General Liability Insurance coverage is required for all events with minimum limits of \$1,000,000 Each Occurrence, \$2,000,000 Products & Completed Operations Aggregates, \$2,000,000 General Aggregate. Liquor Liability Insurance of \$1,000,000 to \$5,000,000 Per Occurrence is required for any event where liquor is being served.

All Insurance must endorse the City of Scottsdale as an Additional Insured. A separate insurance addendum with additional insurance requirements may be added to this application and become part of this contract.

I have a race event and have submitted a copy of the participant waiver that includes waiving liability against the city of Scottsdale and holding the city of Scottsdale harmless? NO

I have included a copy of the insurance certificate showing appropriate limits and coverages as required and naming City of Scottsdale as additional insured? NO

## Application Authorization

**WARRANTY:** Applicant warrants that the information provided in this application is true and accurate to the best of Applicant's knowledge and belief.

**INDEMNIFICATION:** To the fullest extent allowed by law, the Applicant agrees to defend, indemnify and hold harmless the City, its officers, officials, representatives, agents, employees and volunteers from and against all allegations, demands, proceedings, suits, actions, claims, damages, losses, expenses, including but not limited to, attorney fees, court costs, the cost of appellate proceedings, and all claim adjusting and handling expenses, arising from or related to any acts or omissions of the permit holder or its agents, contractors and subcontractors related to the Special Event including any claims, damages, or losses resulting from the City's or its employees' or agents' negligence.

The Applicant's signature below authorizes a City representative to inspect a special event on City or private property at any time, including setup.

**AUTHORITY:** For special events on public property, the Applicant warrants:

I am the permittee or an authorized agent of the permittee with authority to legally bind the permittee (an agent may sign only if the event is on private property) and agree to the conditions of this permit.

Signature of Applicant - must be the same person listed on application.

Printed Name     JEFF BARTON

Date     10/1/2024

Title of Applicant     PARTNER

Bell

Thompson  
Rock

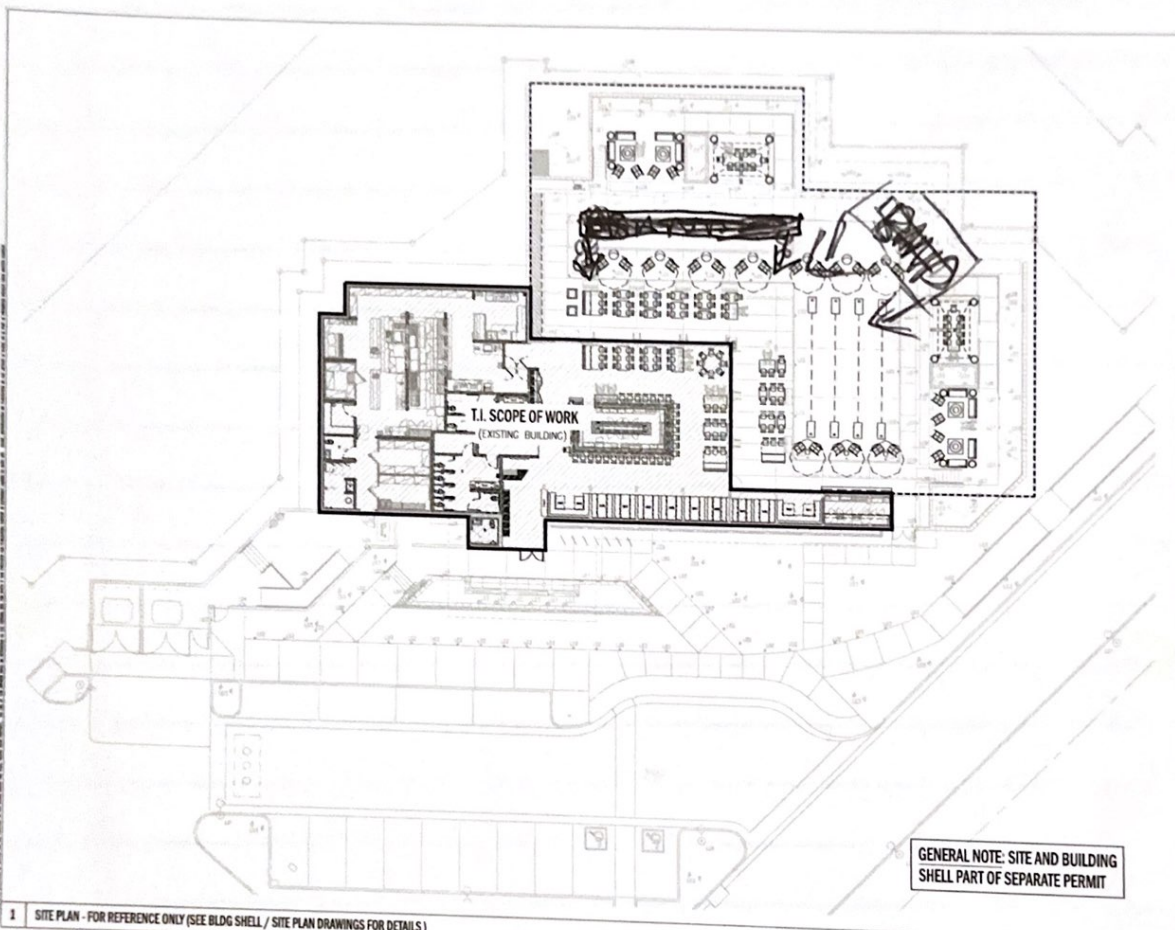

AV3  
design studio

THE VIG - McDOWELL MOUNTAIN  
RESTAURANT / BAR - TENANT IMPROVEMENT

GENERAL NOTE: SITE AND BUILDING SHELL PART OF SEPARATE PERMIT

1 SITE PLAN - FOR REFERENCE ONLY (SEE BLDG SHELL / SITE PLAN DRAWINGS FOR DETAILS)

A.101

BAND WILL BE SET UP BELOW  
ROCK WALL ON SE CORNER

Bell

Thompson

Reef

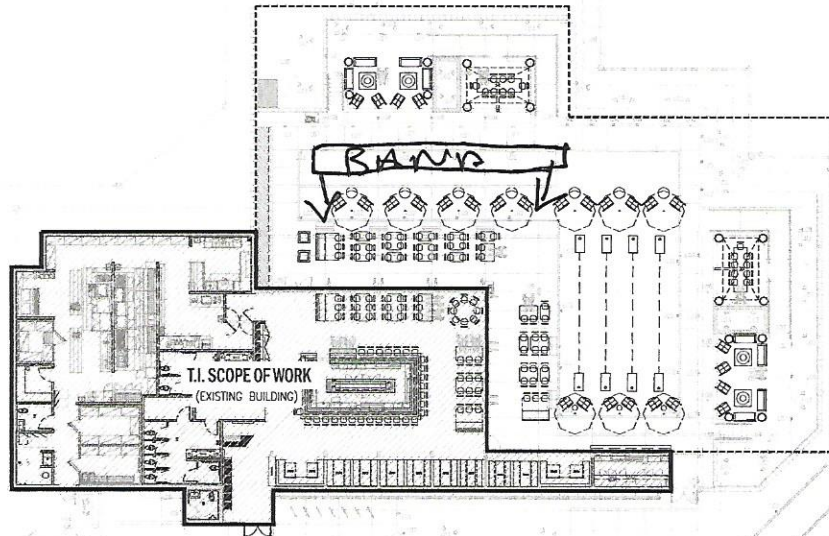

**AV3**  
design studio  
ARCHITECTURE/INTERIOR DESIGN  
802.278.3397

**THE VIG - McDOWELL MOUNTAIN**  
RESTAURANT / BAR - TEAVANT IMPROVEMENT  
1019 E. BELL ROAD, SCOTTSDALE, ARIZONA, 85260

REV	DATE	ISSUED FOR

DRAWN BY:	TSW
PROJECT #:	15012
DATE:	2014 07 08

SCALE:



GENERAL NOTE: SITE AND BUILDING SHELL PART OF SEPARATE PERMIT

1 SITE PLAN - FOR REFERENCE ONLY (SEE BLDG SHELL / SITE PLAN DRAWINGS FOR DETAILS)

SCALE: 1" = 16'-0"

**A.101**  
SITE PLAN