



Special Event Application

4/17/2023

Standard

63-SE-2023

Are there any changes from previous years? NO

Event Elements

Elements CULTURAL, EDUCATIONAL, ENTERTAINMENT

Description THIS BRINGS COLLECTORS AND ENTHUSIASTS TOGETHER TO SHARE COFFEE AND PASTRIES ALONG WITH COOL AND UNIQUE CARS. IT'S EDUCATIONAL TO THOSE WANTING TO LEARN AND GET INTO CARS.

Public Property Criteria

Are there any cross promotions or collaborations with local businesses to encourage sales or visibility? NO

CARISSIMO - VINTAGE AND RARE AUTOMOBILES AND ANDREOLI PARTNER TO SHOWCASE FOOD AND CARS

Explain any anticipated regional, national, or international attendance.

INTERNATIONAL CARS AND FOOD FROM ITALY!

Is Scottsdale promoted in the special event marketing? NO

Explain how the community benefits from the event from a civic or cultural perspective.

A CHANCE TO SEE RARE CARS , AND ANDREOLI OPENS UP EARLY TO SERVE PASTRIES AND COFFEE.

Does your event require a paid fee for participants and/or spectators? NO

Event Equipment

Stages NO Tables, Chairs, Furniture NO

Generators NO Inflatables NO

Portable Bars NO Amplified Sound NO

Speakers YES QTY: 1-2 Temporary Restrooms NO

Fencing NO BBQ Grills or Propane Use NO

Lighting NO Tents/Canopies NO

Vendor Sales

Retail Merchandise NO Food And Non-Alcoholic Beverages NO

Food Trucks NO Alcohol NO

Services NO

Signage Plan

On-Site Signs? YES QTY: 2 TYPE: VERTICAL FEATHER/BLADE

Off-Premise Signs? NO



Special Event Application

4/17/2023

Standard

63-SE-2023

Signage Plan Description:

THEY SAY ESPRESSOS AND ENGINES TO DIRECT THE SHOW CARS INTO THE PARKING LOT

Parking Plan

City parking lot	NO	City parking garage	NO
On-street parking	NO	On-site parking	YES
Off-site parking	NO	Shuttle service from off-site parking areas	NO
Valet service	NO	Rider Provider	NO

Parking Plan Description

PARKING LOT OF ANDREOLI AND THE ADJACENT LOT

Street Use

Street or Alley Use

Street Closure : NO

Public Parking Use

Parking Closure : YES

Parking Name : 8880 E VIA LINDA

Closure Dates : 9/23/2023 6:00:00 AM - 5/25/2024 10:00:00 AM

Sidewalk Use

Sidewalk Closure : NO

Barricade Company

Entertainment - Amplification/Sound Plan

Entertainment

Sound Monitoring

Time and type of outside sound and sound check times

Plan for sound monitoring, containment, and mitigation

Police/Security

Security Personnel

Inhouse Security YES Estimated Number : 5

Hired Security NO



Special Event Application

4/17/2023

Standard

63-SE-2023

Off Duty Police NO

Scottsdale Fire Department and Medical Standby Services

Fire Department Permit Required NO

Medical Standby NO

Fire Apparatus/Personnel Standby Required NO

Insurance

Insurance: Event activities on City/public property must be covered by insurance that protects the event sponsor/applicant and the City of Scottsdale. Various types and levels of liability insurance are required depending on the event. The required coverage and limits will be at the discretion of the Risk Management Division depending on the size and scope of the event. It is recommended that you submit your application and receive a determination on coverage and amounts before purchasing insurance coverage. Please refer to the Special Events Users Guide for more detailed information.

The following is a general guideline of the minimum limits that will be required:

Commercial General Liability Insurance coverage is required for all events with minimum limits of \$1,000,000 Each Occurrence, \$2,000,000 Products & Completed Operations Aggregates, \$2,000,000 General Aggregate. Liquor Liability Insurance of \$1,000,000 to \$5,000,000 Per Occurrence is required for any event where liquor is being served.

All Insurance must endorse the City of Scottsdale as an Additional Insured. A separate insurance addendum with additional insurance requirements may be added to this application and become part of this contract.

I have a race event and have submitted a copy of the participant waiver that includes waiving liability against the city of Scottsdale and holding the city of Scottsdale harmless? NO

I have included a copy of the insurance certificate showing appropriate limits and coverages as required and naming City of Scottsdale as additional insured? NO

Application Authorization

WARRANTY: Applicant warrants that the information provided in this application is true and accurate to the best of Applicant's knowledge and belief.

INDEMNIFICATION: To the fullest extent allowed by law, the Applicant agrees to defend, indemnify and hold harmless the City, its officers, officials, representatives, agents, employees and volunteers from and against all allegations, demands, proceedings, suits, actions, claims, damages, losses, expenses, including but not limited to, attorney fees, court costs, the cost of appellate proceedings, and all claim adjusting and handling expenses, arising from or related to any acts or omissions of the permit holder or its agents, contractors and subcontractors related to the Special Event including any claims, damages, or losses resulting from the City's or its employees' or agents' negligence.

The Applicant's signature below authorizes a City representative to inspect a special event on City or private property at any time, including setup.

AUTHORITY: For special events on public property, the Applicant warrants:

I am the permittee or an authorized agent of the permittee with authority to legally bind the permittee (an agent may sign only if the event is on private property) and agree to the conditions of this permit.



Special Event Application

4/17/2023

Standard

63-SE-2023

Signature of Applicant - must be the same person listed on application.

Printed Name GIAN PAUL SCORZO

Date 4/17/2023

Title of Applicant PRESIDENT

Parking Lot car show

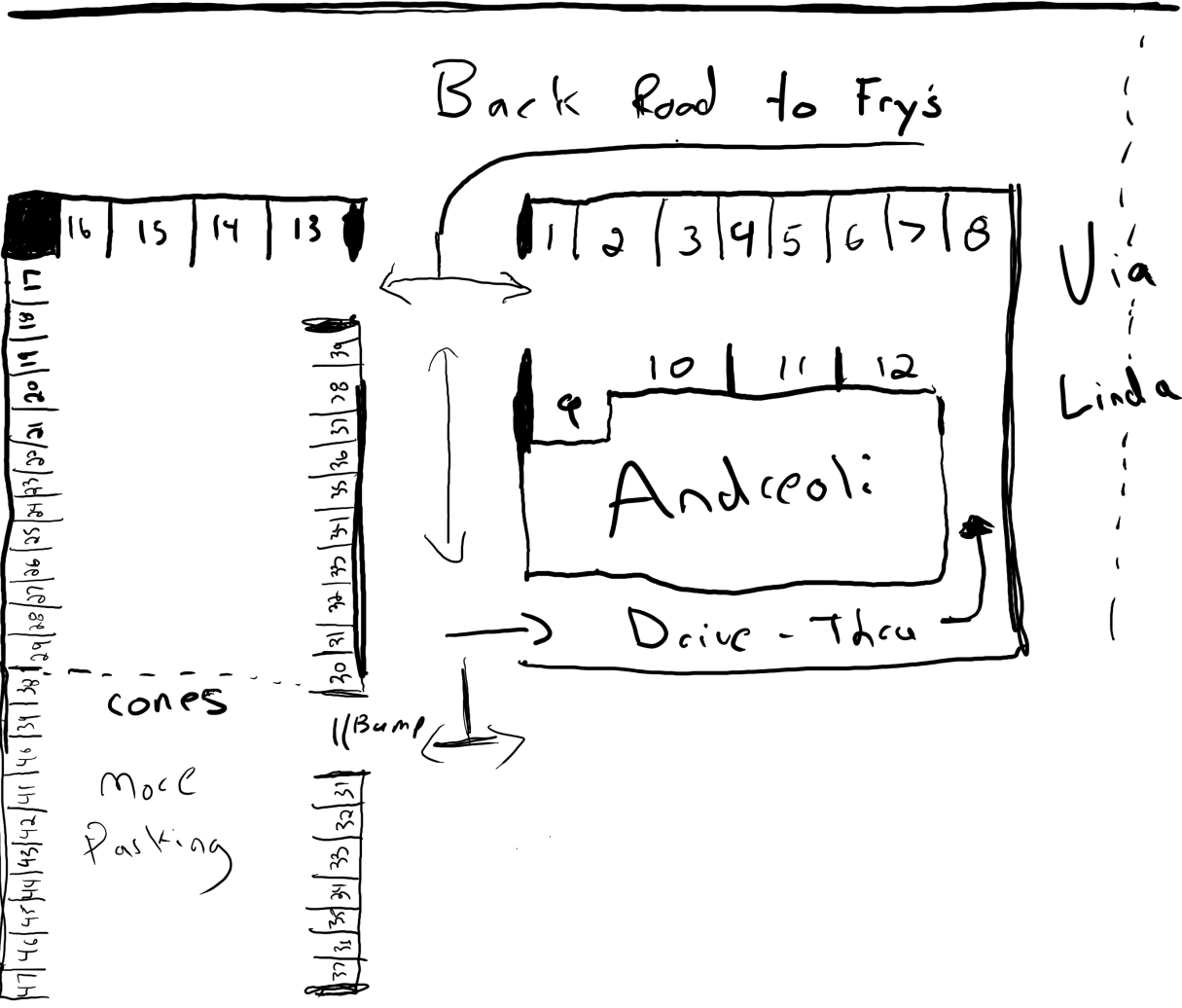

Site Photographs

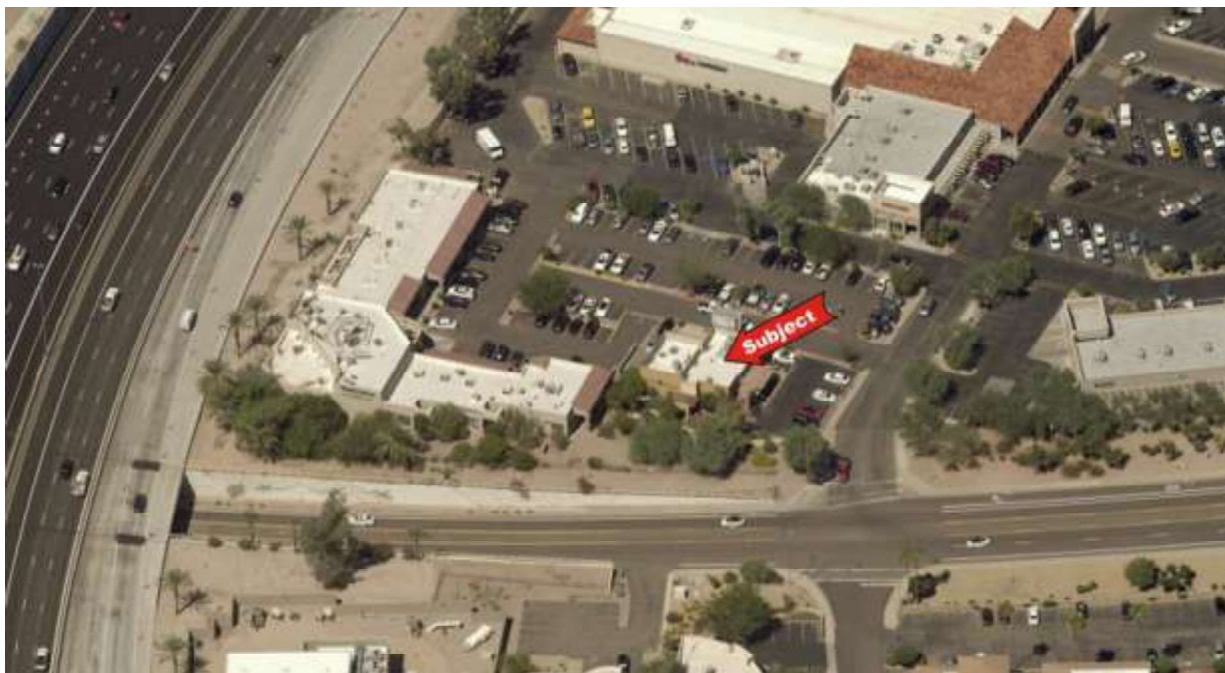

VIEW LOOKING NORTH AT THE SUBJECT SITE

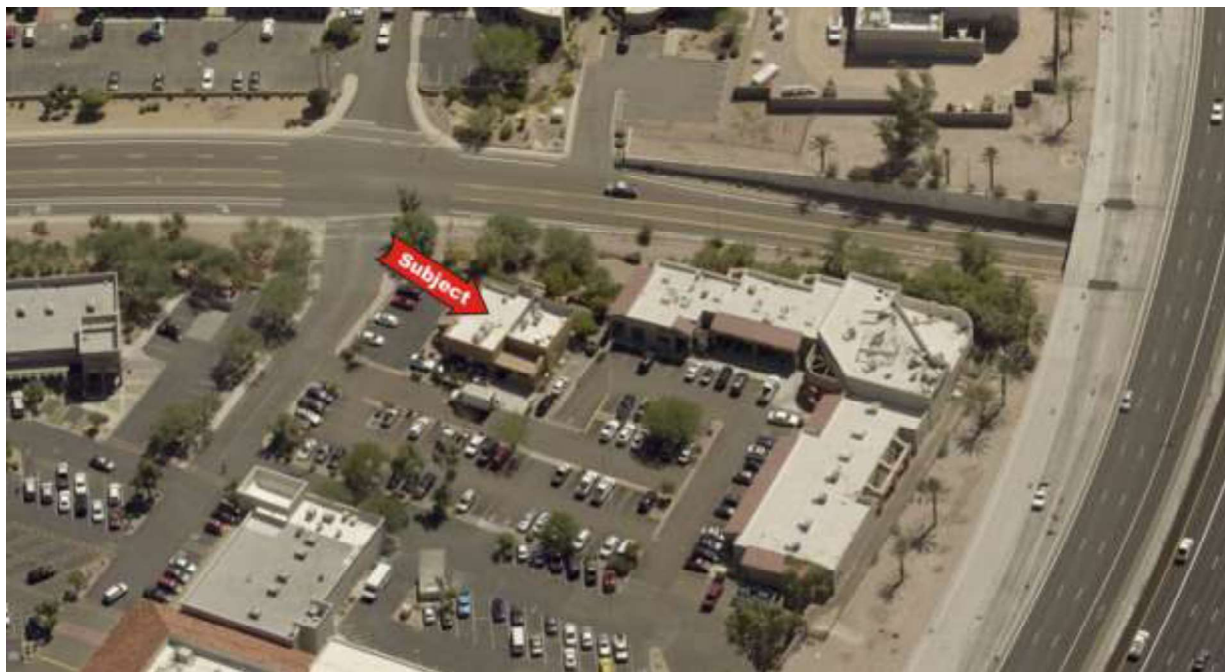

VIEW LOOKING SOUTH AT THE SUBJECT SITE

LEGEND

- Survey Control Point (See Monument Table)
- Property Line
- Find Survey Monument (See Monument Table)
- (See Monument Table)
- Schedule "B" Item
- 24 inch Vertical Curb & Gutter
- 6 inch Concrete Curb
- Asphalt
- Concrete Surface
- Fence
- Retaining Wall
- Flow Preventer
- Drywell Or Catch Basin
- Electric Box
- Electric Transformer
- Gas Meter
- Light Pole
- Disinfectant Space
- Light Pole
- Sewer Clean Out
- Sprinkler Hook-Up (fire department)
- Telephone Riser
- Water Meter
- Water Valve
- See Reference Documents
- Measured

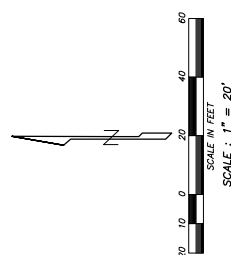

LINE	BEARING	DISTANCE
L17	S 89°46'51" E	65.32'
L16	S 89°46'51" E	65.32'
L15	S 89°46'51" E	65.32'
L14	N 23°09'24" E	12.84'
L13	S 89°46'51" E	65.32'
L12	N 66°49'22" W	62.00'
L11	S 23°09'24" W	65.00'
L10	N 66°49'22" W	62.00'
L9	N 66°49'22" W	62.00'
L8	N 66°49'22" W	62.00'
L7	N 66°49'22" W	62.00'
L6	N 66°49'22" W	62.00'
L5	N 66°49'22" W	62.00'
L4	N 66°49'22" W	62.00'
L3	N 66°49'22" W	62.00'
L2	N 66°49'22" W	62.00'
L1	N 66°49'22" W	62.00'
L18	S 89°46'51" E	65.32'
L19	S 89°46'51" E	65.32'
L20	S 89°46'51" E	65.32'
L21	S 89°46'51" E	65.32'
L22	S 89°46'51" E	65.32'
L23	S 89°46'51" E	65.32'
L24	S 89°46'51" E	65.32'
L25	S 89°46'51" E	65.32'
L26	S 89°46'51" E	65.32'
L27	S 89°46'51" E	65.32'
L28	S 89°46'51" E	65.32'
L29	S 89°46'51" E	65.32'
L30	S 89°46'51" E	65.32'

MONUMENT TABLE	
1	S. 1/4 COR. SEC. 10, T10N, R10E, BRASS CAP - ALSO
2	FINO REFERENCE MONUMENT - E.L.M. BRASS CAP - ALSO
3	S. 45°52'02" W, 39.97', STAMPED "M.L. 33 FT.",
4	FINO REFERENCE MONUMENT PER (R) & AS SHOWN ON (R)
5	FINO 1.25" REBAR NO. 10.
6	FINO BRASS CAP FLUSH.
7	FINO ADOT ALUMINUM CAP.
8	FINO PK NAIL & WASHER, L.S. 42137 PER (R)
9	CALCD POSITION PER FINO SURVEY MONUMENTS & PER (R)
10	SET 1.25" REBAR W/CAP, L.S. 31020
11	SET PK NAIL & WASHER, L.S. 31020
12	FINO CST NAIL & WASHER, L.S. 42137 PER (R)
13	FINO PK NAIL
14	FINO PK NAIL
15	FINO PK NAIL
16	FINO PK NAIL
17	FINO PK NAIL
18	FINO PK NAIL
19	FINO PK NAIL
20	FINO PK NAIL



CURVE	RADIUS	ARC LENGTH	BETA ANGLE	CHORD BEARING	CHORD LENGTH
C10	2000.00'	276.62'	20°48'58"	N 12°27'48" E	223.87'
C11	15.00'	23.55'	90°00'00"	N 21°49'22" W	21.21'
C12	15.00'	23.55'	90°00'00"	S 66°13'37" W	26.42'
C13	2000.00'	641.11'	25°14'42"	S 87°37'16" W	638.36'
C14	2000.00'	251.74'	0°77'43"	N 85°35'24" W	251.58'
C15	1625.00'	282.82'	0°52'59"	N 18°39'49" E	282.53'

ALTA / NPS'S LAND TITLE SURVEY
8880 E. VIA LINDA, SCOTTSDALE, ARIZONA

STATEWIDE SERVICE IN ARIZONA
 WWW.ALTIASURVEYS.COM
 7800 N. 70th AVENUE TEL: (602) 878-8900
 SUITE 804 SCOTTSDALE, AZ 85260 FAX: (602) 878-8999
 COLUMBIA@ALTIASURVEYS.COM

ALLIANCE
 LAND SURVEYING, LLC

DATE: 1-6-17 JOB NO: 193218
 SHEET: 2 OF 2

Landlord Permission for Use of the Parking Lot Area for the Events

From: Jacque Chilton <jchilton@umcres.com>

Sent: Tuesday, June 13, 2023 10:56 AM

To: Gian Paul Scorzo <gscorzo@gocarissimo.com>

Cc: Shannon, Holli <HShannon@Scottsdaleaz.gov>; Sumners, Cheryl <csumners@scottsdaleaz.gov>; Barry, Erin <EBarry@Scottsdaleaz.gov>

Subject: Re: Espressos & Engines -PLEASE ACCEPT THESE CONDITIONS

⚠ External Email: Please use caution if opening links or attachments!

As the property manager for the shopping center I accept the terms listed below.

Jacque Chilton

UMC Real Estate Services

4545 E Shea Boulevard

Suite 242

Phoenix, AZ 85028

480.467.2550 office

602.538.3310 cell

480.467.2561 fax

jchilton@umcres.com