



Special Event Application

6/23/2025

Standard

69-SE-2025

Event Information

Event Name DREAMY DRAW MUSIC FESTIVAL
 Event Location 3939 N DRINKWATER BL LOT 1
 Event URL DREAMYDRAWFEST.COM/
 Event Description DREAMY DRAW COUNTRY & AMERICAN INDIE MUSIC FESTIVAL — HAPPENING NOVEMBER 7TH & 8TH AT SCOTTSDALE CIVIC CENTER. TWO-DAY, TICKETED EVENT.

Event Dates

Event Dates (2)	Start Date	End Date	Participant Attendance	Other Attendance
	FRI 11/7/2025 3:00 PM	FRI 11/7/2025 11:00 PM	6000	100
	SAT 11/8/2025 12:00 PM	SAT 11/8/2025 11:00 PM	6000	100

Setup Date MON 11/3/2025 6:00 AM - 08:00 PM
 Teardown Date MON 11/10/2025 6:00 AM - 09:00 PM

Applicant Information

Applicant OH WOW COMPANY
 Applicant Address 1036 FERNWOOD PACIFIC DR
 Applicant City TOPANGA, CA 90290
 Applicant Name ALEXIS DORRITY
 Title OWNER
 Phone (312) 852-1494 Email ALEXIS@OHWOWCOMPANY.COM
 On-Site Contact CLARISSA WALTER
 Title OPERATIONS DIRECTOR
 Phone (312) 852-1494 Email CLARISSA@OHWOWCOMPANY.COM
 Applicant Experience WE ARE COMING UP TO OUR THIRD YEAR FOR PRODUCING THIS EVENT.WE ANNUALLY PRODUCED SEVERAL EVENTS IN THE FOLLOWING STATES; AZ, CA, UT.

Prior Events

Has this event been produced before? YES
 Is this an annual event? YES Previous Years : 2
 Are there any changes from previous years? YES WE ARE EXPANDING TO THE SCOTTSDALE STADIUM GIANTS SPRING TRAINING FACILITY AND ARE REQUESTING TO USE THE 2ND LEVEL OF THE LIBRARY PARKING GARAGE FOR INGRESS & EGRESS BETWEEN THE STADIUM & CIVIC CENTER

Event Elements

Elements CIVIC, ENTERTAINMENT, RECREATIONAL
 Description WE CURATE A DIVERSE FOOD, ENTERTAINMENT AND COMMUNITY EXPERIENCE BY CULTIVATING THE SOUTHWEST AESTHETIC THROUGH THE SHARED LOVE OF MUSIC



Special Event Application

6/23/2025

Standard

69-SE-2025

Public Property Criteria

Are there any cross promotions or collaborations with local businesses to encourage sales or visibility? NO

THIS IS A CO-PRO WITH SCOTTSDALE ARTS

Explain any anticipated regional, national, or international attendance.

HISTORICALLY OUR ATTENDANCE IS 40% OUT OF STATE WHICH DRIVES TOURISM AND WE BOOK NATIONAL AND LOCAL ACTS TO PERFORM.

Is Scottsdale promoted in the special event marketing? YES

WE PROMOTE SCOTTSDALE AS THE PERFECT DESTINATION DURING NOVEMBER, WITH SUNNY WEATHER AND WARM TEMPS WHILE NEARBY STATES ARE EXPERIENCING COLDER CONDITIONS.

Explain how the community benefits from the event from a civic or cultural perspective.

BRINGING PEOPLE TOGETHER THROUGH MUSIC, ART, AND SHARED EXPERIENCES, CREATING A STRONG SENSE OF COMMUNITY. WHILE ALSO ATTRACTING OUT-OF-STATE VISITORS WHO CONTRIBUTE TO THE CITY'S VISIBILITY AND ECONOMIC GROWTH.

Does your event require a paid fee for participants and/or spectators? YES

Event Equipment

Stages	YES QTY: 3	Tables, Chairs, Furniture	YES
Generators	YES KW SIZE: 125 QTY: 5	Inflatables	NO
Portable Bars	YES QTY: 8	Amplified Sound	YES
Speakers	YES QTY: 5+	Temporary Restrooms	YES QTY: 100
Fencing	YES HEIGHT: 8 TYPE: FESTIVAL T-STAND FENCE	BBQ Grills or Propane Use	YES
Lighting	YES	Tents/Canopies	YES
		10' x 10' QTY: 10 10' x 20' QTY: 5	
		20' x 20' QTY: 5	

Vendor Sales

Retail Merchandise	YES QTY: 5	Food And Non-Alcoholic Beverages	YES QTY: 5
Food Trucks	YES QTY: 10	Alcohol	YES QTY: 8
Services	YES QTY: 3	APPLICATION FOR : EXTENSION FOR PREMISES AND SPECIAL EVENT LIQUOR LICENSE	
EPI - Promotions for Bars, Waste Rentals -porta jons, ECT... to be finalized		ORGANIZATION NAME : SCOTTSDALE ARTS	

Signage Plan

On-Site Signs? YES QTY: 9 TYPE: BANNER

Off-Premise Signs? YES QTY: 9 TYPE: OFF SITE TRAFFIC DIRECTIONAL

Signage Plan Description:

*PLEASE SEE ATTACHED MAP FOR SIGNAGE PLAN WITH MORE INFORMATION.



Special Event Application

6/23/2025

Standard

69-SE-2025

Parking Plan

City parking lot	NO	City parking garage	NO
On-street parking	NO	On-site parking	NO
Off-site parking	NO	Shuttle service from off-site parking areas	NO
Valet service	NO	Rider Provider	NO

Parking Plan Description

Street Use

Street or Alley Use

Street Closure : YES
 Number of Lanes : 1
 Direction : N
 Street Name : 75TH ST
 Closure Dates : 11/5/2025 10:00:00 AM - 11/9/2025 3:00:00 PM

Public Parking Use

Parking Closure : YES
 Parking Name : CIVIC CENTER LIBRARY EAST SIDE 2ND FLOOR- 3803 N DRINKWATER BLVD
 Closure Dates : 11/6/2025 10:00:00 AM - 11/9/2025 3:00:00 PM

Sidewalk Use

Sidewalk Closure : YES
 Sidewalk Name : DRINKWATER BLVD EAST SIDE BETWEEN CIVIC CENTER & GIANTS STADIUM
 Closure Dates : 11/6/2025 10:00:00 AM - 11/9/2025 3:00:00 PM

Barricade Company

Company Name : SOUTHWEST BARRICADES
 Contact Name : ABEL
 Phone Number : (602) 788-2222

Entertainment - Amplification/Sound Plan

Entertainment

LIVE BAND, PRE-RECORDED MUSIC, SPEAKER/ANNOUNCER

Sound Monitoring

Name : TYLER INCE
 Company : OH WOW COMPANY
 Phone Number : (801) 680-1408

Time and type of outside sound and sound check times

THURSDAY 11/6: 5PM-9PM (SOUND CHECK) |
 FRIDAY 11/7: 9AM -11PM
 SATURDAY 11/8: 9AM-11PM

Plan for sound monitoring, containment, and mitigation

WE WILL MONITOR THE SOUND BY USING DB MONITOR AROUND PERIMETERS



Special Event Application

6/23/2025

Standard

69-SE-2025

Police/Security

Security Personnel

Inhouse Security YES Estimated Number : 30

Hired Security YES Estimated Number : 80
Company Name : PRO EM
Contact : ELIZABETH GILL
Phone : (480) 848-0192

Off Duty Police YES Estimated Number : 20 Scottsdale Police : YES Other Agency : NO

Scottsdale Fire Department and Medical Standby Services

Fire Department Permit Required YES

Medical Standby NO

Fire Apparatus/Personnel Standby Required NO

Insurance

Insurance: Event activities on City/public property must be covered by insurance that protects the event sponsor/applicant and the City of Scottsdale. Various types and levels of liability insurance are required depending on the event. The required coverage and limits will be at the discretion of the Risk Management Division depending on the size and scope of the event. It is recommended that you submit your application and receive a determination on coverage and amounts before purchasing insurance coverage. Please refer to the Special Events Users Guide for more detailed information.

The following is a general guideline of the minimum limits that will be required:

Commercial General Liability Insurance coverage is required for all events with minimum limits of \$1,000,000 Each Occurrence, \$2,000,000 Products & Completed Operations Aggregates, \$2,000,000 General Aggregate. Liquor Liability Insurance of \$1,000,000 to \$5,000,000 Per Occurrence is required for any event where liquor is being served.

All Insurance must endorse the City of Scottsdale as an Additional Insured. A separate insurance addendum with additional insurance requirements may be added to this application and become part of this contract.

I have a race event and have submitted a copy of the participant waiver that includes waiving liability against the city of Scottsdale and holding the city of Scottsdale harmless? NO

I have included a copy of the insurance certificate showing appropriate limits and coverages as required and naming City of Scottsdale as additional insured? NO

Application Authorization

WARRANTY: Applicant warrants that the information provided in this application is true and accurate to the best of Applicant's knowledge and belief.

INDEMNIFICATION: To the fullest extent allowed by law, the Applicant agrees to defend, indemnify and hold harmless the City, its officers, officials, representatives, agents, employees and volunteers from and against all allegations, demands, proceedings, suits, actions, claims, damages, losses, expenses, including but not limited to, attorney fees, court costs, the cost of appellate proceedings, and all claim adjusting and handling expenses, arising from or related to any acts or omissions of the permit holder or its agents, contractors and subcontractors related to the Special Event including any claims, damages, or losses resulting from the City's or its employees' or agents' negligence.



Special Event Application

6/23/2025

Standard

69-SE-2025

The Applicant's signature below authorizes a City representative to inspect a special event on City or private property at any time, including setup.

AUTHORITY: For special events on public property, the Applicant warrants:

I am the permittee or an authorized agent of the permittee with authority to legally bind the permittee (an agent may sign only if the event is on private property) and agree to the conditions of this permit.

Signature of Applicant - must be the same person listed on application.

Printed Name ALEXIS DORRITY

Date 6/23/2025

Title of Applicant OWNER

Site Plan

<https://www.scribblemaps.com/maps/view/Dreamy-Draw-2025-NEW/lhz3VBHv0L>

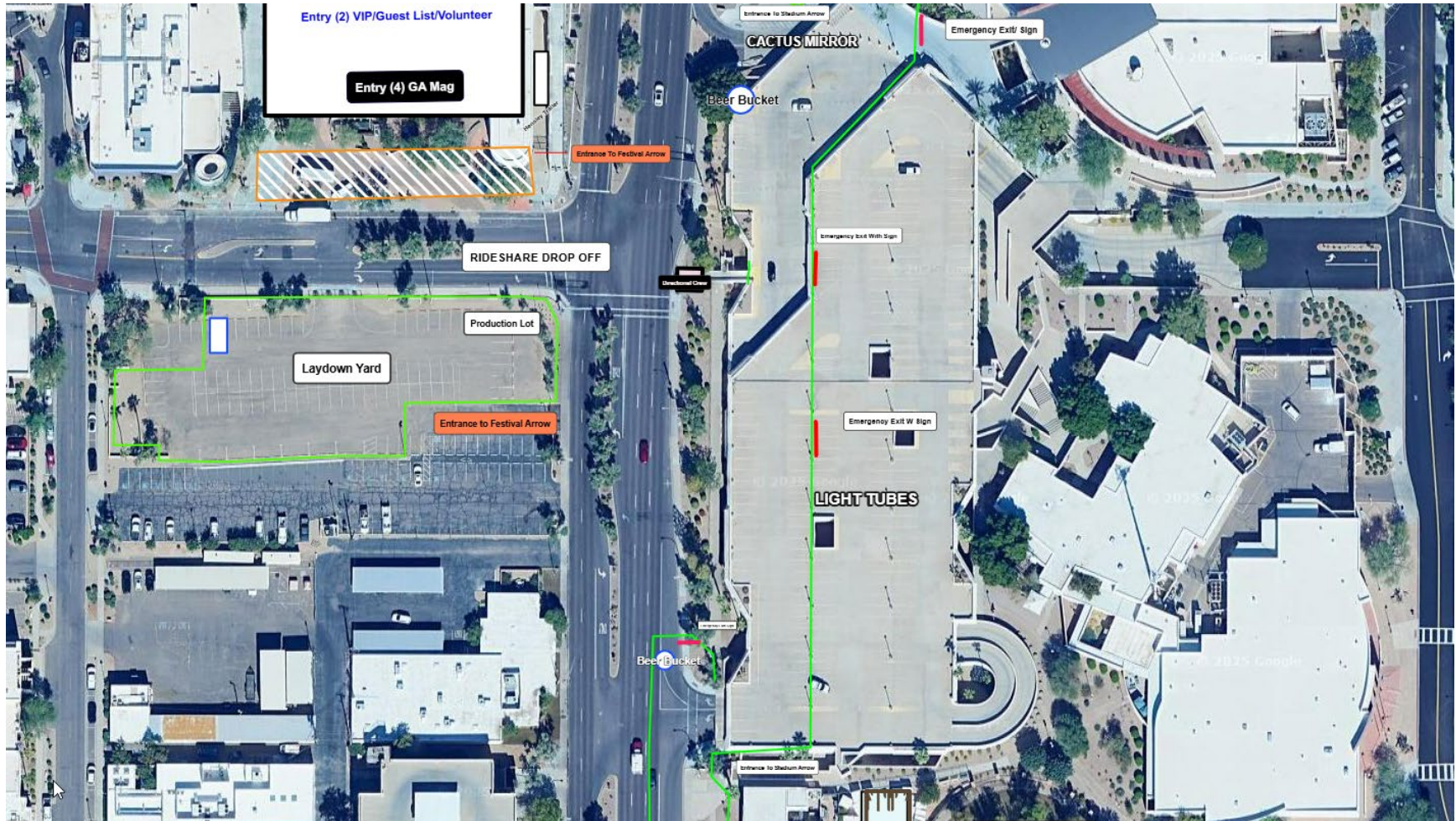

Site Plan

<https://www.scribblemaps.com/maps/view/Dreamy-Draw-2025-NEW/lhz3VBHv0L>

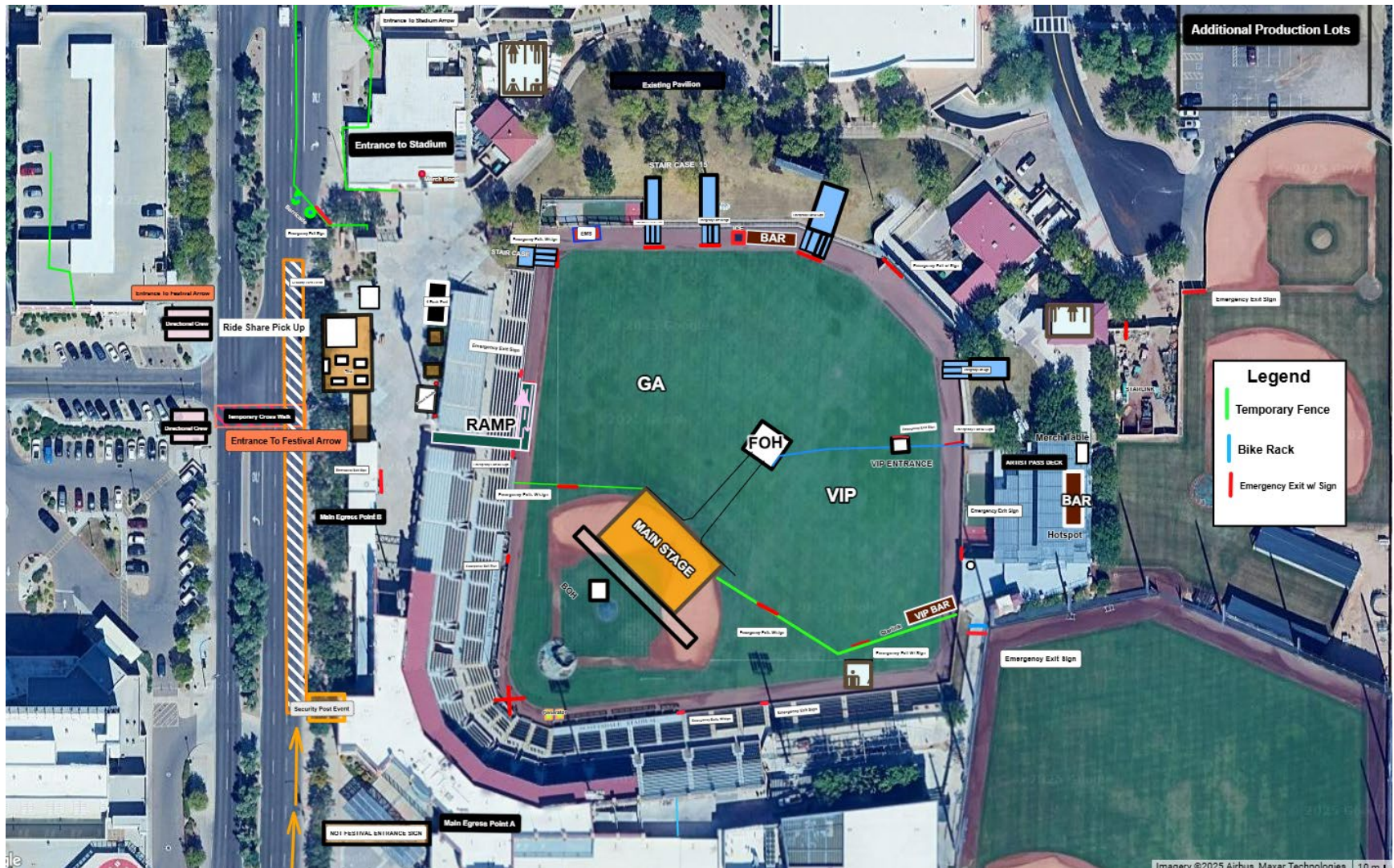







Additional Production Lots

B=Banner
 A=Flag
 F=114

Legend

- Temporary Fence
- Bike Rack
- Emergency Exit w/ Sign

-  Pedestrian Wall
-  Sign Stand
-  Type I Barricade
-  Vertical Panels

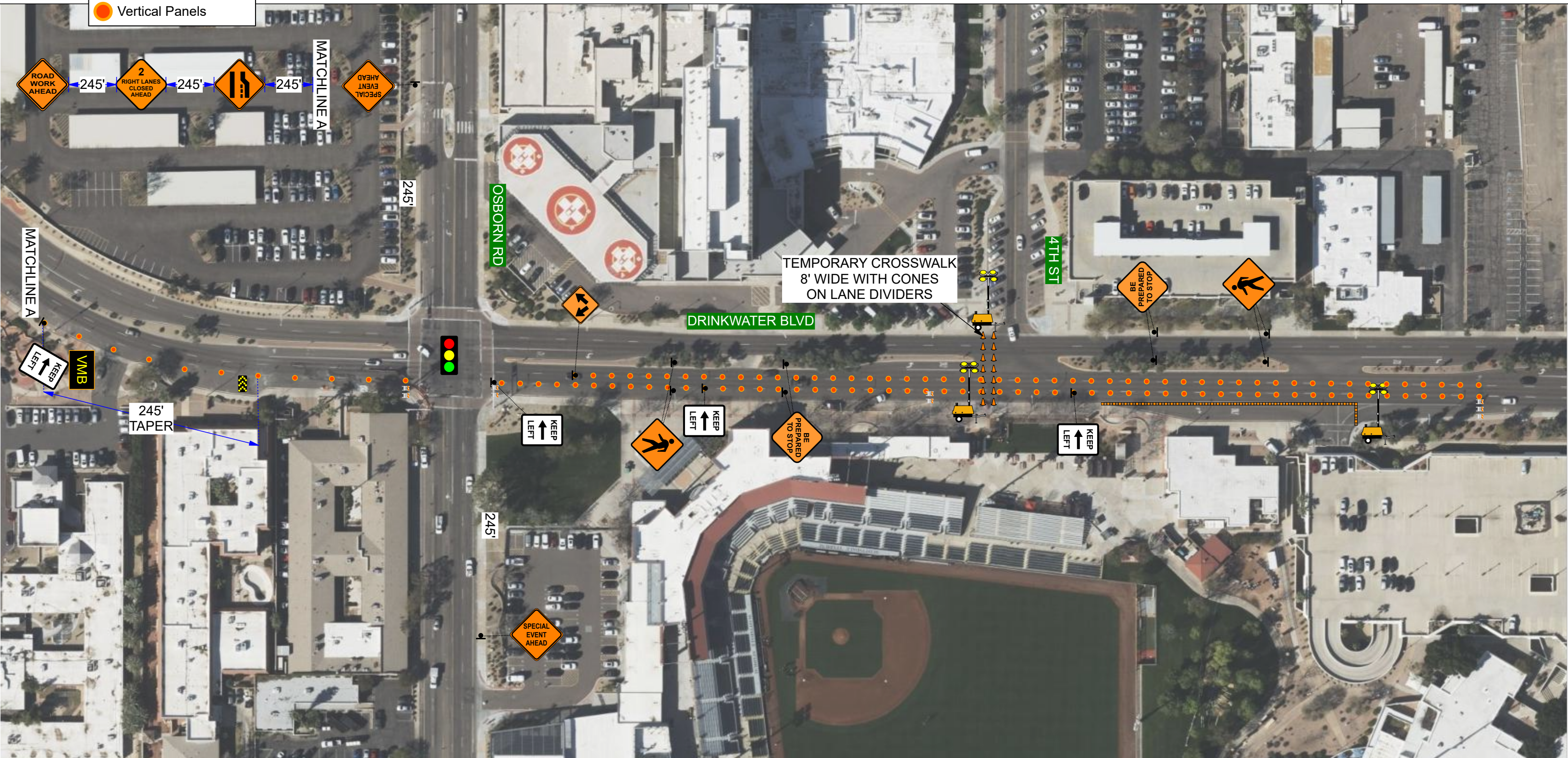





OFF-DUTY POLICE OFFICER IS REQUIRED IF WORKZONE IS WITHIN 300' OF SIGNALIZED INTERSECTIONS



TCP NAME: Dreamy Draw Music Festival 2025 Right 2 COS PERMIT #: Permit
 LOCATION: Drinkwater Blvd & 2nd St
 START DATE: 11-7-2025 END DATE: 11-9-2025
 WORK HOURS: 8:30am - 3:30pm Mon.-Fri. 24 HOUR
 10:00 pm - 5:00am Sun. - Thur.
 CONTRACTOR: Oh Wow Company
 CONTACT PERSON: Alex Lewis
 EMAIL: alex@ohwowcompany.com

COMPASS  POSTED SPEED 
 OTHER: 11-7 : 6:00 am to 12:00 am
11-8 : 10:00 am to 12:00 am
 PHONE: 760-488-3949

CONTACT: Matthew Grots
 EMAIL: matthew@traffcade.com

-  Pedestrian Wall
-  Sign Stand
-  Type I Barricade
-  Vertical Panels

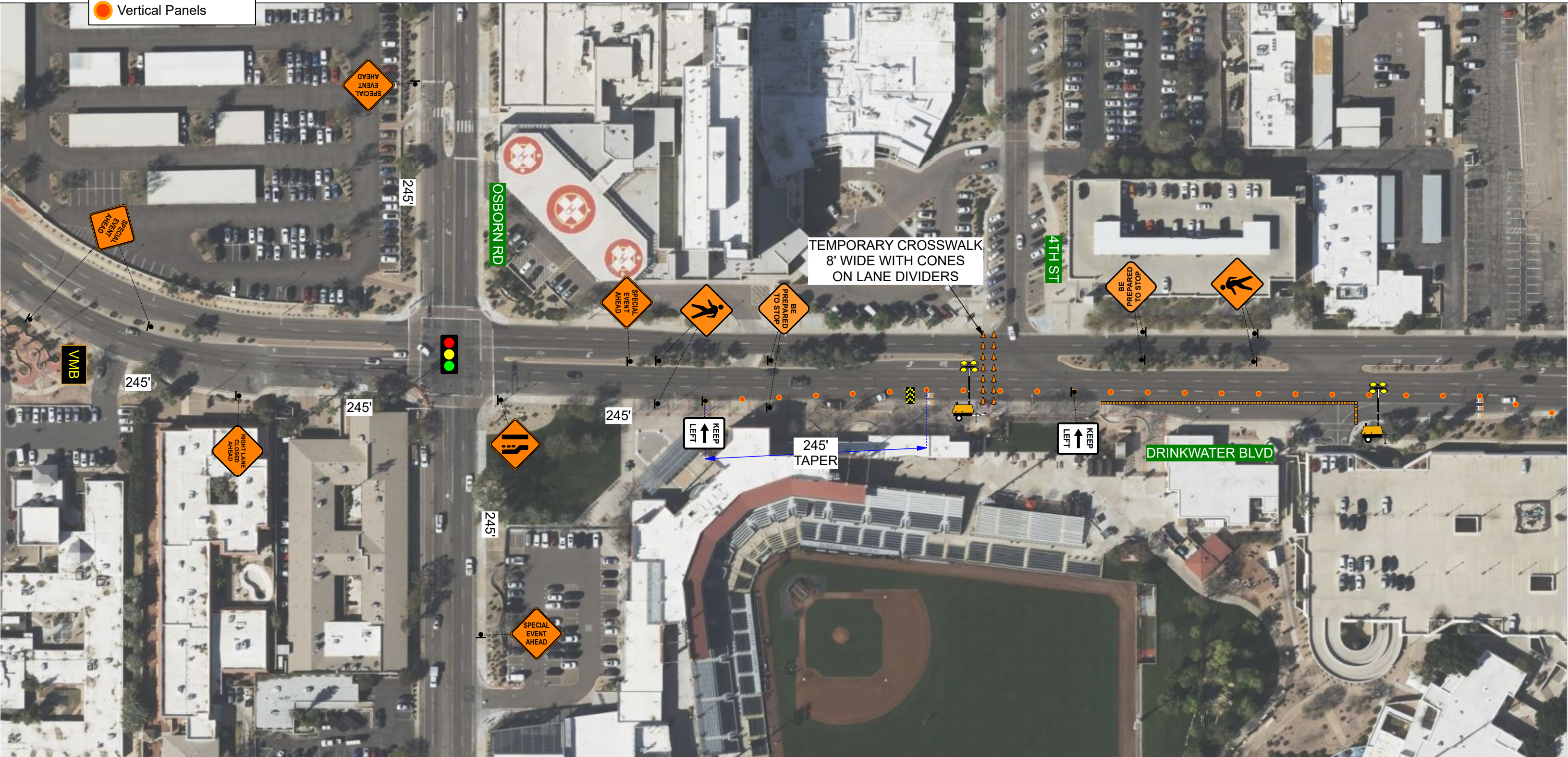

OFF-DUTY POLICE OFFICER IS REQUIRED IF WORKZONE IS WITHIN 300' OF SIGNALIZED INTERSECTIONS

BARRICADE COMPANY INFO



CONTACT: Matthew Grots
EMAIL: matthew@trafficaid.com

TCP NAME: Dreamy Draw Music Festival 2025 **COS PERMIT #:** Permit

LOCATION: Drinkwater Blvd & 2nd St

START DATE: 11-7-2025 **END DATE:** 11-9-2025

WORK HOURS: 8:30am - 3:30pm Mon.-Fri. 24 HOUR
 10:00 pm - 5:00am Sun. - Thur.

CONTRACTOR: Oh Wow Company

CONTACT PERSON: Alex Lewis

EMAIL: alex@ohwowcompany.com

COMPASS  **POSTED SPEED**

SPEED LIMIT
35

OTHER: 11-7 : 6:00 am to 12:00 am
11-8 : 10:00 am to 12:00 am

PHONE: 760-488-3949

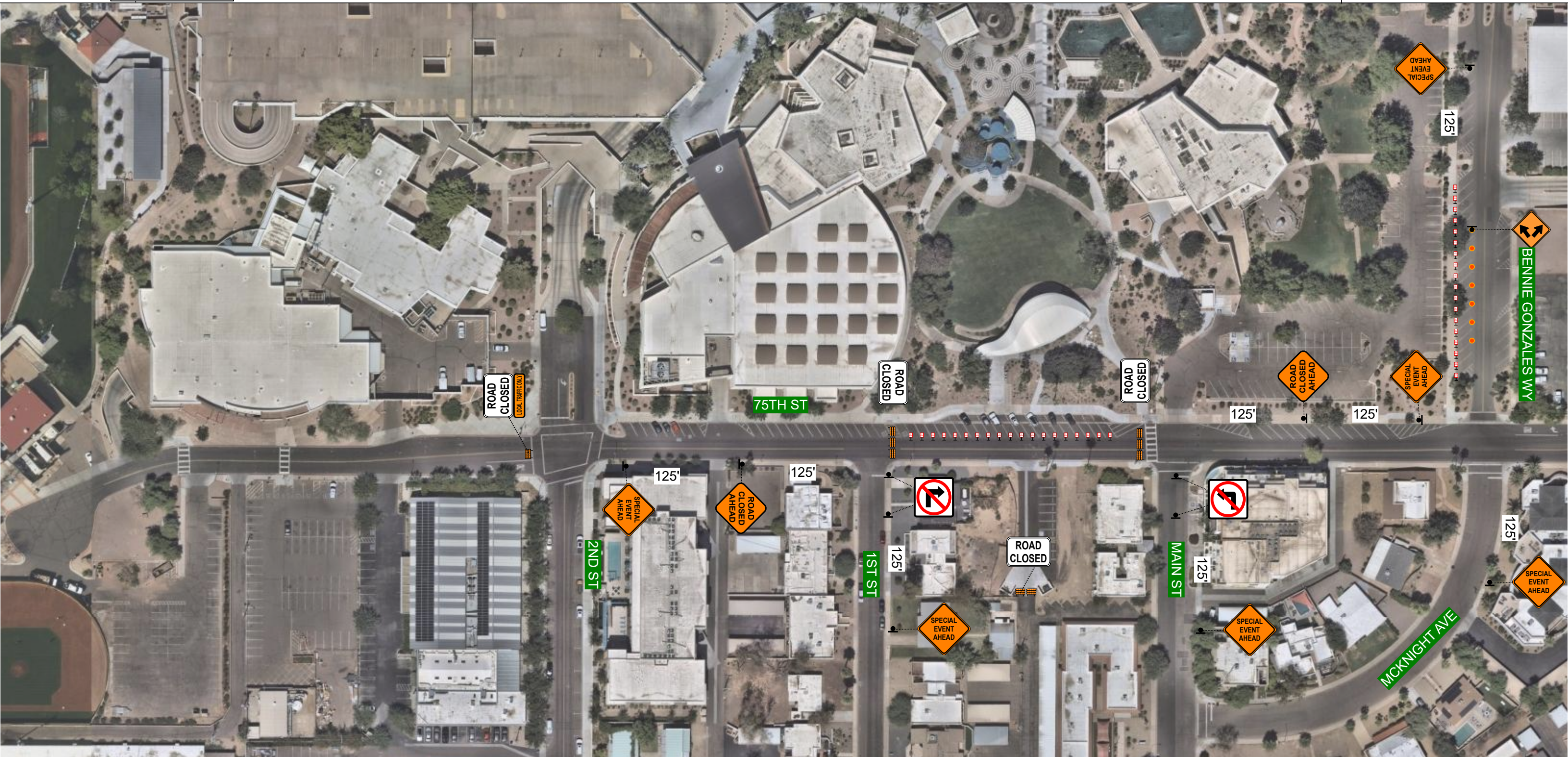



OFF-DUTY POLICE OFFICER IS REQUIRED IF WORKZONE IS WITHIN 300' OF SIGNALIZED INTERSECTIONS

BARRICADE COMPANY INFO



CONTACT: Matthew Grots
EMAIL: matthew@trafficaid.com

TCP NAME: Dreamy Draw Music Festival 2025 COS PERMIT #: Permit
 LOCATION: 75th St & Main St
 START DATE: 11-7-2025 END DATE: 11-9-2025
 WORK HOURS: 8:30am - 3:30pm Mon.-Fri. 24 HOUR
 10:00 pm - 5:00am Sun. - Thur.
 CONTRACTOR: Oh Wow Company
 CONTACT PERSON: Alex Lewis
 EMAIL: alex@ohwowcompany.com

COMPASS  POSTED SPEED 
 OTHER: 11-7 : 6:00 am to 12:00 am
 11-8 : 10:00 am to 12:00 am
 PHONE: 760-488-3949





OFF-DUTY POLICE OFFICER IS REQUIRED IF WORKZONE IS WITHIN 300' OF SIGNALIZED INTERSECTIONS



CONTACT: Matthew Grotts
 EMAIL: matthew@trafficaid.com

TCP NAME: Dreamy Draw Music Festival 2025 Detour Route COS PERMIT #: Permit
 LOCATION: 75th St & Main St
 START DATE: 11-7-2025 END DATE: 11-9-2025
 WORK HOURS: 8:30am - 3:30pm Mon.-Fri. 24 HOUR
 10:00 pm - 5:00am Sun. - Thur.
 CONTRACTOR: Oh Wow Company
 CONTACT PERSON: Alex Lewis
 EMAIL: alex@ohwowcompany.com

COMPASS 	POSTED SPEED 
11-7 : 6:00 am to 12:00 am 11-8 : 10:00 am to 12:00 am	
OTHER: <input checked="" type="checkbox"/>	
PHONE: <u>760-488-3949</u>	



CERTIFICATE OF LIABILITY INSURANCE

DATE (MM/DD/YYYY)
10/8/2025

THIS CERTIFICATE IS ISSUED AS A MATTER OF INFORMATION ONLY AND CONFERS NO RIGHTS UPON THE CERTIFICATE HOLDER. THIS CERTIFICATE DOES NOT AFFIRMATIVELY OR NEGATIVELY AMEND, EXTEND OR ALTER THE COVERAGE AFFORDED BY THE POLICIES BELOW. THIS CERTIFICATE OF INSURANCE DOES NOT CONSTITUTE A CONTRACT BETWEEN THE ISSUING INSURER(S), AUTHORIZED REPRESENTATIVE OR PRODUCER, AND THE CERTIFICATE HOLDER.

IMPORTANT: If the certificate holder is an ADDITIONAL INSURED, the policy(ies) must have ADDITIONAL INSURED provisions or be endorsed. If SUBROGATION IS WAIVED, subject to the terms and conditions of the policy, certain policies may require an endorsement. A statement on this certificate does not confer rights to the certificate holder in lieu of such endorsement(s).

PRODUCER Marsh & McLennan Agency LLC 8605 E. Raintree Drive, Suite 200 Scottsdale AZ 85260	CONTACT NAME: Soo Murray PHONE (A/C, No, Ext): E-MAIL ADDRESS: Soo.Murray@MarshMMA.com	FAX (A/C, No):
	INSURER(S) AFFORDING COVERAGE	
INSURED SCOTCUL-C1 Scottsdale Arts fka Scottsdale Cultural Council 7380 E. 2nd St. Scottsdale AZ 85251	INSURER A: Philadelphia Indemnity Insurance Co.	NAIC # 18058
	INSURER B: CopperPoint Insurance Company	NAIC # 14216
	INSURER C:	
	INSURER D:	
	INSURER E:	
INSURER F:		

COVERAGES **CERTIFICATE NUMBER:** 676405881 **REVISION NUMBER:**

THIS IS TO CERTIFY THAT THE POLICIES OF INSURANCE LISTED BELOW HAVE BEEN ISSUED TO THE INSURED NAMED ABOVE FOR THE POLICY PERIOD INDICATED. NOTWITHSTANDING ANY REQUIREMENT, TERM OR CONDITION OF ANY CONTRACT OR OTHER DOCUMENT WITH RESPECT TO WHICH THIS CERTIFICATE MAY BE ISSUED OR MAY PERTAIN, THE INSURANCE AFFORDED BY THE POLICIES DESCRIBED HEREIN IS SUBJECT TO ALL THE TERMS, EXCLUSIONS AND CONDITIONS OF SUCH POLICIES. LIMITS SHOWN MAY HAVE BEEN REDUCED BY PAID CLAIMS.

INSR LTR	TYPE OF INSURANCE	ADDL INSD	SUBR WVD	POLICY NUMBER	POLICY EFF (MM/DD/YYYY)	POLICY EXP (MM/DD/YYYY)	LIMITS	
A	<input checked="" type="checkbox"/> COMMERCIAL GENERAL LIABILITY <input type="checkbox"/> CLAIMS-MADE <input checked="" type="checkbox"/> OCCUR GEN'L AGGREGATE LIMIT APPLIES PER: <input type="checkbox"/> POLICY <input type="checkbox"/> PRO-JECT <input checked="" type="checkbox"/> LOC OTHER:	Y	Y	PHPK2566860009	7/1/2025	7/1/2026	EACH OCCURRENCE	\$ 1,000,000
							DAMAGE TO RENTED PREMISES (Ea occurrence)	\$ 1,000,000
							MED EXP (Any one person)	\$ 20,000
							PERSONAL & ADV INJURY	\$ 1,000,000
							GENERAL AGGREGATE	\$ 2,000,000
							PRODUCTS - COMP/OP AGG	\$ 2,000,000
								\$
A	<input checked="" type="checkbox"/> AUTOMOBILE LIABILITY <input checked="" type="checkbox"/> ANY AUTO <input type="checkbox"/> OWNED AUTOS ONLY <input checked="" type="checkbox"/> HIRED AUTOS ONLY <input type="checkbox"/> SCHEDULED AUTOS <input checked="" type="checkbox"/> NON-OWNED AUTOS ONLY	Y	Y	PHPK2566860009	7/1/2025	7/1/2026	COMBINED SINGLE LIMIT (Ea accident)	\$ 1,000,000
							BODILY INJURY (Per person)	\$
							BODILY INJURY (Per accident)	\$
							PROPERTY DAMAGE (Per accident)	\$
								\$
A	<input checked="" type="checkbox"/> UMBRELLA LIAB <input type="checkbox"/> EXCESS LIAB <input checked="" type="checkbox"/> DED <input checked="" type="checkbox"/> RETENTION \$ 10,000 <input type="checkbox"/> CLAIMS-MADE			PHUB868473009	7/1/2025	7/1/2026	EACH OCCURRENCE	\$ 5,000,000
							AGGREGATE	\$ 5,000,000
								\$
B	WORKERS COMPENSATION AND EMPLOYERS' LIABILITY ANY PROPRIETOR/PARTNER/EXECUTIVE OFFICER/MEMBER EXCLUDED? (Mandatory in NH) If yes, describe under DESCRIPTION OF OPERATIONS below	Y/N	N/A	1019573	7/1/2025	7/1/2026	<input checked="" type="checkbox"/> PER STATUTE <input type="checkbox"/> OTHER	
							E.L. EACH ACCIDENT	\$ 1,000,000
							E.L. DISEASE - EA EMPLOYEE	\$ 1,000,000
							E.L. DISEASE - POLICY LIMIT	\$ 1,000,000
A	Liquor Liability			PHPK2566860009	7/1/2025	7/1/2026	Each cause limit	1,000,000
							Aggregate Limit	1,000,000

DESCRIPTION OF OPERATIONS / LOCATIONS / VEHICLES (ACORD 101, Additional Remarks Schedule, may be attached if more space is required)
The above-indicated Additional Insured and Waiver of Subrogation (WOS) are provided with respects to General Liability when required in a written and executed contract. Such coverage afforded by these policies for the benefit of the additional insured(s) is primary and any other coverage maintained by such additional insured(s) shall be non-contributory when required in a written and executed contract. Subject to all policy terms, conditions and exclusions

Sexual Abuse Molestation coverage included per Policy #PHPK2566860008: Occurrence Form- Limits \$1,000,000 Aggregate/ \$1,000,000 Each Abusive Conduct/\$0 Deductible

Supporting endorsements attached include: CG2026 04 13; CG2001 04 13; CG2404 05 09

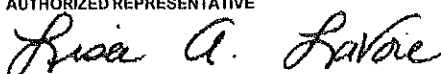
CERTIFICATE HOLDER City of Scottsdale 7380 E 2nd St Scottsdale AZ 85251	CANCELLATION SHOULD ANY OF THE ABOVE DESCRIBED POLICIES BE CANCELLED BEFORE THE EXPIRATION DATE THEREOF, NOTICE WILL BE DELIVERED IN ACCORDANCE WITH THE POLICY PROVISIONS.
	AUTHORIZED REPRESENTATIVE 

From: Murrell, Ed

Sent: Tuesday, October 28, 2025 1:21 PM

To: Jory Greenfield <jory.greenfield@awpsafety.com>; Alex Lewis <alex@ohwowcompany.com>; Clarissa Walter <clarissa@ohwowcompany.com>

Cc: Bailey, Christian - 1150 <ChBailey@ScottsdaleAz.Gov>; Safsten, Daniel - 1304

<DSafsten@scottsdaleaz.gov>; Sumners, Cheryl <csumners@scottsdaleaz.gov>; Shaffer III, Wesley - 825 <wshaffer@Scottsdaleaz.Gov>; Dipiazza, Christopher - 1177 <CDiPiazza@Scottsdaleaz.gov>; Plata, Tony <TPlata@Scottsdaleaz.gov>

Subject: DDMF 11/28 TCP field meeting follow up.

Group – below are a few of the items we discussed today.

- Drinkwater SB install No U Turn sign in median, install be Scottsdale/ Traffic Engineering (TE) ASAP
- Ride Share signs pick up by SD TE from SPD sign cage (court parking lot) drop at SD Stadium E/side of Drinkwater, drop off- 11/7 am
- TCP set uptimes, Fri 11/7 6:00 am Restriction #1 with/for water barriers.
- Friday Restriction #2 set up 12:30 pick up 12:00 am
- Saturday Restriction #2 set up ~~12:30 pm~~ **11:00 am**, pick up 12:00 am
- Sunday all devices picked up.
- Traffic Engineering field check TCP Friday 11:00 am & Saturday @ 12:00 pm.
- No Parking signs 72 hr. (Tuesday) in advance Bennie Gonzales & N. 75th St
- N. 75th St hard closure Friday am. Oh Wow will confirm time; discussion was late as possible with City Hall being open.
- Pro-Em or Oh Wow to fill water barriers ¾ per to AWP recommendation.
- Pro-Em will set up ride share on Bennie Gonzales at end of business on Friday.

Let the group know if there is anything else that needs to be addressed.

From: Bennett, Tony - FDFI105 <AnBennett@Scottsdaleaz.gov>

Sent: Wednesday, October 29, 2025 11:51 AM

To: clarissa@ohwowcompany.com; christie.christian@proem.org; Gagnon, Kristi - FDFI106 <KGagnon@Scottsdaleaz.gov>

Cc: Bailey, Christian - 1150 <ChBailey@ScottsdaleAz.Gov>; owteam@ohwowcompany.com; Dipiazza, Christopher - 1177 <CDiPiazza@Scottsdaleaz.gov>; Urban, Kyle <KUrban@Scottsdaleaz.gov>; Swick, Kerry - FD011 <KSwick@ScottsdaleAz.Gov>; Shaffer III, Wesley - 825 <wshaffer@Scottsdaleaz.Gov>; Jamie Prins <jprins@scottsdalearts.org>; Sumners, Cheryl <csumners@scottsdaleaz.gov>

Subject: Dreamy Draw Site Plan 10.29.2025

Hello Clarissa and Company,

Your occupant numbers of 8,000 total with 2,000 in VIP are acceptable to the SFD.

Reference the attached marked up site plan dated 10.29.2025.

Inside Stadium Field GA Section:

- 1) Ramp shall be made ADA compliant.
 - a. SFD is not approving structural stability for any ramp and/or stairs.
- 2) Exit stair 6 (adj. to ramp) is the only viable existing exit through bleacher section.
 - a. Use EXIT banner for this stair exit
- 3) Exit Stairs numbered 1, 2, and 3 are three sets of 60" wide stairs.
- 4) Exit Stairs numbered 4 and 5 are four sets of 60" wide stairs.
- 5) Maintenance Tunnel shall remain open when field is occupied, and mark location with an EXIT banner placed at least 7' above ground level to bottom of banner.

Inside Stadium Field VIP Section:

- 1) Relocate Main Entrance to VIP section closer to the warning track.
 - a. This entrance shall be at least 120" wide.
- 2) Relocate the Emergency Exit Gate 1 in Bike Rack fencing from the warning track to the west, closer to FOH.
 - a. This EE Gate 1 shall be at least 120" wide and swing into the GA section.
 - b. Use an EXIT banner to mark EE Gate 1.
- 3) Temporary Fencing from Stage Right to VIP Bar to extend down to 1st base line bleachers.
 - a. Use one Emergency Exit aka EE Gate 2.
 - b. This EE Gate 2 shall be at least 72" wide and swing in direction of egress (towards bleachers).
 - c. Mark this EE Gate 2 location with an EXIT Flag.
 - d. Note: Gate near VIP Bar is not and Emergency Exit.
- 4) Temporary Fencing from Stage Left to bleachers shall not have an Emergency Exit Gate.
 - a. If an access gate is desired, it shall remain unmarked.
- 5) Charro Tunnel Exit shall remain open when field is occupied.
 - a. Mark this tunnel exit with an EXIT banner placed at least 7' above ground level to bottom of banner.
 - b. Use an Exit Flag and/or Exit banner on lawn, to be seen while exiting tunnel east, directing public north along 1st base line to Exit Gate marked with an Exit Flag.
- 6) Exit Stairs 1 and 2 lead into bleacher section.
 - a. Mark general location with an Exit Flag and mark each Exit Stair with an Exit banner.
 - b. Use an Exit banner OR Exit Flag at bleacher vomitory for directing egress.

Outside Stadium Field:

- 1) Use Exit Flags at 5 Exit Gate locations starting on concourse near ramp, moving north and east to Maintenance tunnel exit. 6th Exit Flag at concrete stairs leading down to Exit Gates southeast of maintenance yard. 7th Exit Flag at south end of Charro Lodge. 8th Exit Flag and/or banner located outside Charro tunnel directing public north to Exit Flag 9. Exit Flag 9 is located at Exit Gate leading to 75th St, as seen from Exit Flag / banner 8.
- 2) Use Exit Banner at Exit Gate located at Main Entrance fencing corral. This Exit Gate needs to be as large as possible, min. 16' wide and swing outward.

Please call me with any questions.

Thank you,

Tony S. Bennett

Fire Inspector II / Investigator

anbennett@scottsdaleaz.gov

Cell: 480-828-0645



NO PARKING TOW-AWAY ZONE

AFTER 5:00 PM

FRI., NOV 7th

***Vehicles will be towed per
A.R.S. 28-872(b) & 28-4834***

**If your vehicle was towed call the
Scottsdale Police at 480-312-5000**

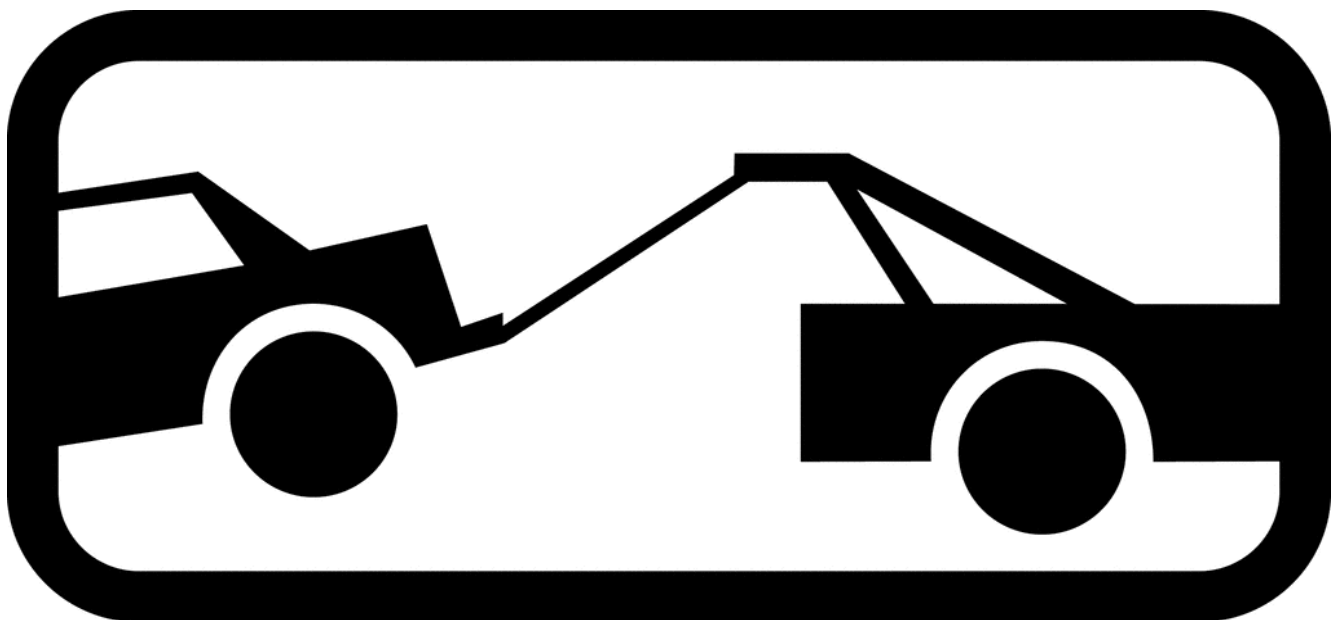

75th Street

NO PARKING TOW-AWAY ZONE

**AFTER 11 AM
WED., NOV 5th**

***Vehicles will be towed per
A.R.S. 28-872(b) & 28-4834***

**If your vehicle was towed call the
Scottsdale Police at 480-312-5000**

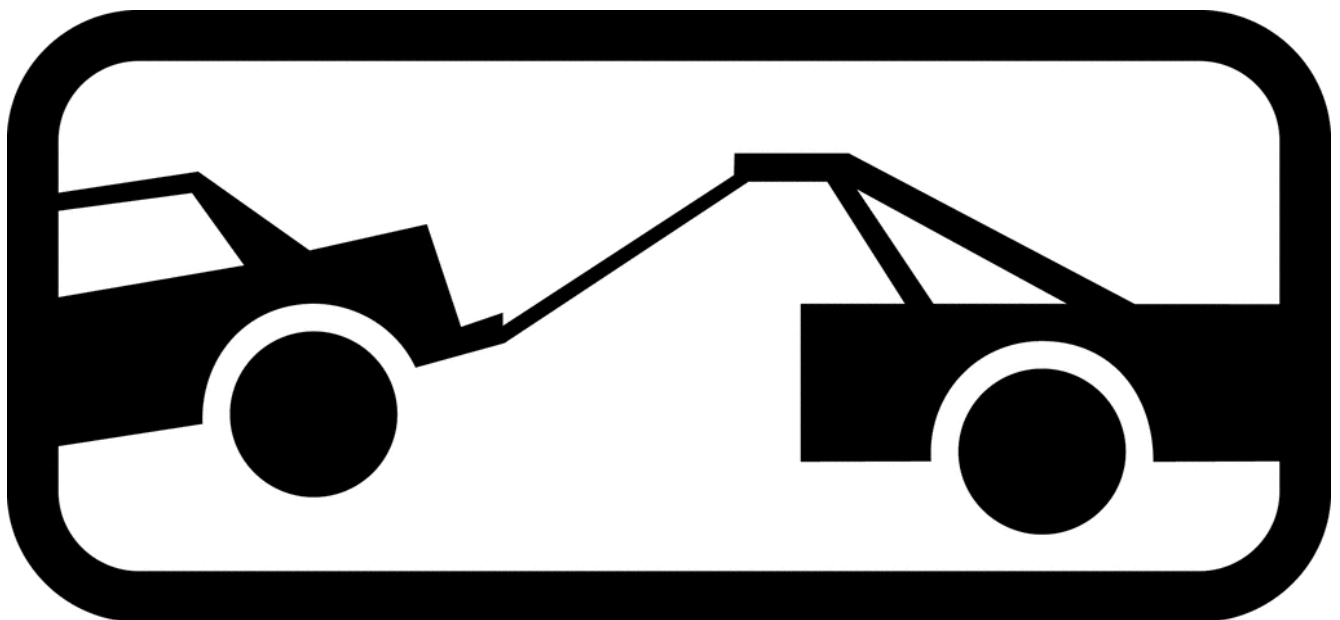



DAILY SCHEDULES

FRIDAY • NOV 7TH		SET TIMES		
	BRONCO STAGE	STAMPEDE STAGE	PONCHO STAGE	JB'S LAWN
11:00 PM	THE LUMINEERS 9:30 - 11:00 PM			ASHRIDGE BAND 9:30 - 10:45 PM
10:00 PM				
9:00 PM		MARCUS KING BAND 8:00 - 9:15 PM	SIDNEY BIRD 8:00 - 9:00 PM	
8:00 PM	THEE SACRED SOULS 7:00 - 8:30 PM			KATIE MAE & THE LUBRICATION 7:00 - 8:00 PM
7:00 PM		RICHY MITCH & THE COAL MINERS 6:00 - 7:00 PM	IZZY MAHOUBI 6:00 - 7:00 PM	
6:00 PM	HOUNDMOUTH 5:00 - 6:00 PM			SOPHIA RANKIN & THE SOUND 5:00 - 6:00 PM
5:00 PM		HOVDY 4:00 - 5:00 PM	BUMMER GIRL 4:00 - 5:00 PM	
4:00 PM	FIELD MEDIC 3:00 - 4:00 PM			
3:00 PM				

GATES OPEN AT 2:45 PM

WHO ARE YOU EXCITED TO SEE?

SATURDAY • NOV 8TH

SET TIMES

	BRONCO STAGE	STAMPEDE STAGE	PONCHO STAGE	JB'S LAWN
11:00 PM	VAMPIRE WEEKEND 9:30 - 11:00 PM			MELLOW TOAD 10:00 - 11:00 PM
10:00 PM		LOCAL NATIVES 8:30 - 9:45 PM	CHROMEO (DJ SET) 8:30 - 9:45 PM	
9:00 PM				
8:00 PM	FATHER JOHN MISTY 7:15 - 8:30 PM			PRACTICALLY PEOPLE 7:15 - 8:15 PM
7:00 PM		SAINT MOTEL 6:15 - 7:15 PM	FLYING MOJITO BROS 6:15 - 7:15 PM	
6:00 PM	ASHE 5:15 - 6:15 PM			DESERT MUSIC PROJECT 5:15 - 6:15 PM
5:00 PM		ASIRIS 4:15 - 5:15 PM	BARRETT (DJ SET) 4:15 - 5:15 PM	
4:00 PM	WELLS FERRARI 3:15 - 4:15 PM			SILVER LAKE RODEO 3:15 - 4:15 PM
3:00 PM		JACK VAN CLEAF 2:15 - 3:15 PM		
2:00 PM	DELOYD ELZE 1:15 - 2:15 PM			
1:00 PM				

GATES OPEN AT 1:00 PM

DREAMY DRAW *MUSIC FESTIVAL*

SITE MAP





DREAMY *DRAW* MUSIC FESTIVAL

TICKETS

NOVEMBER 7TH - 8TH, 2025 | SCOTTSDALE, AZ

FESTIVAL PASSES

DREAMY DRAW IS A YEARLY CELEBRATION OF MUSIC, ART, AND COMMUNITY IN SCOTTSDALE, ARIZONA. FEATURING A DIVERSE LINEUP AND A VIBRANT ATMOSPHERE, THE FESTIVAL BLENDS AMERICANA, INDIE, AND OUTLAW SOUNDS TO CREATE A UNIQUE AND UNFORGETTABLE EXPERIENCE.

BUY TICKETS



CHOOSE YOUR FESTIVAL EXPERIENCE

FROM GA TO ALL-OUT LUXURY, CHOOSE HOW YOU ENJOY DREAMY DRAW

GA PASSES



VIP PASSES

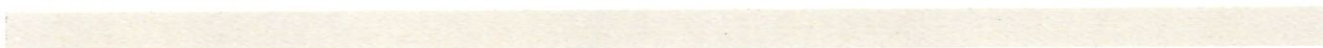

ARTIST PASS



CORPORATE PACKAGES



LOCKERS

SEE [HERE](#) FOR MORE INFO



AWAKEN YOUR DESERT SPIRIT

[BUY TICKETS](#)